

| CHANNEL | NORTH | EAST |
|---------|------------|------------|
| 21 | 2161818.86 | 8028718.06 |
| 22 | 2161806.18 | 8024470.68 |
| 23 | 2161828.13 | 8023698.08 |
| 24 | 2162011.81 | 8023671.48 |
| 25 | 2162218.51 | 8022130.20 |
| 26 | 2163871.87 | 8022258.12 |

| CHANNEL | EAST | NORTH |
|---------|---------------|------------|
| 02 | 2' 589' 72.67 | 8023299.00 |
| 09 | 2' 57555.10 | 8023877.38 |
| 10 | 2' 58396.75 | 8023789.58 |
| 11 | 2' 57158.34 | 8022719.34 |
| 12 | 2' 58256.20 | 8024797.57 |
| 13 | 2' 58977.13 | 8023718.20 |
| 14 | 2' 58630.55 | 8023733.87 |
| 15 | 2' 57243.59 | 8024077.57 |
| 16 | 2' 57520.28 | 8023966.38 |
| 17 | 2' 57577.89 | 8024244.58 |
| 18 | 2' 58699.74 | 8024794.28 |
| 19 | 2' 58896.13 | 8023853.70 |
| 20 | 2' 58700.15 | 8024628.95 |

PRELIMINARY ISSUE
THIS PLAN ISSUED FOR
ADVANCE INFORMATION ONLY

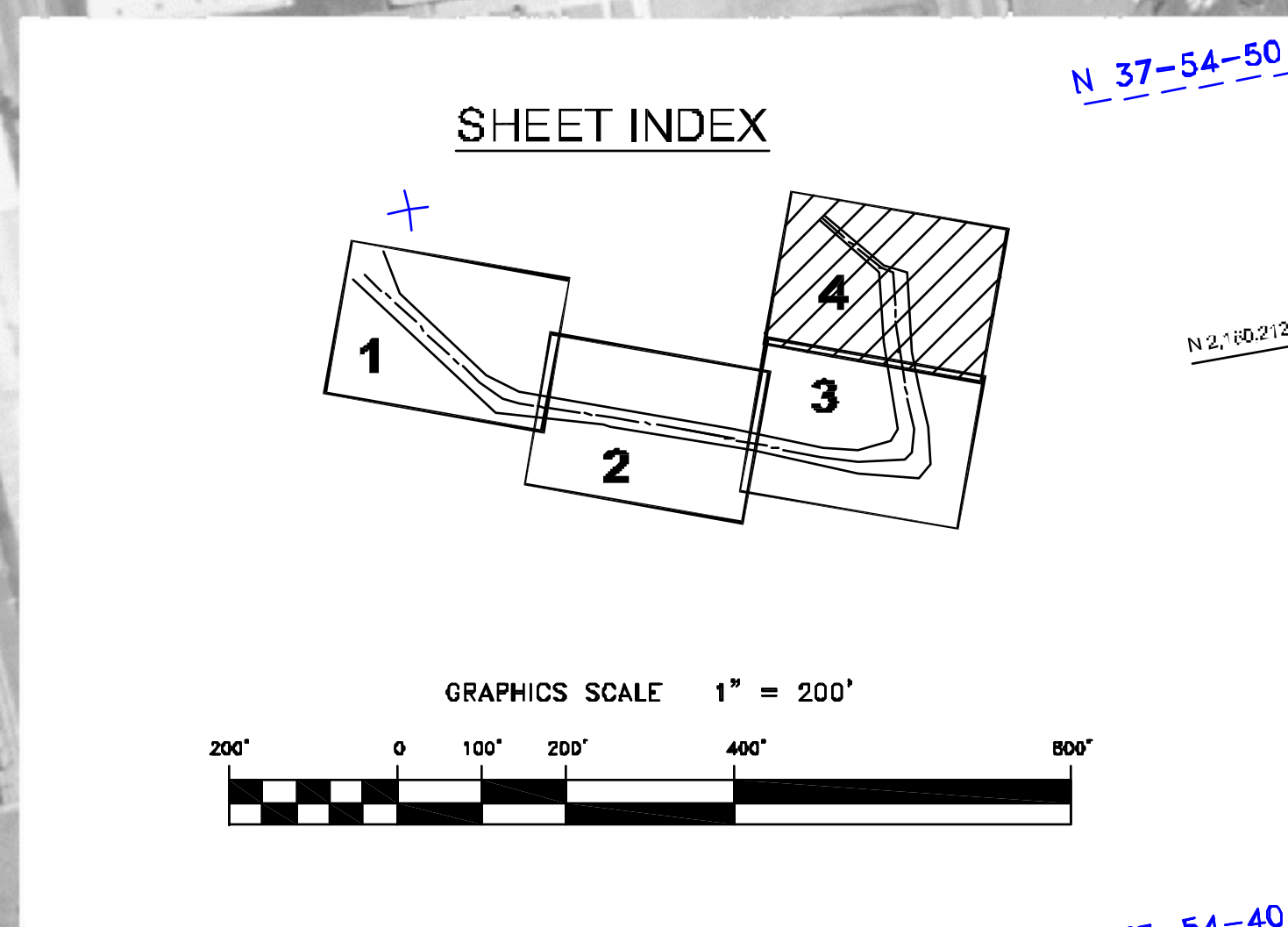

US Army Corps of Engineers
San Francisco District
1455 Market Street
San Francisco, CA 94103

| Mark | Description | Date | Appr. |
|------|-------------|------|-------|
| | | | |
| | | | |
| | | | |
| | | | |

| | | | | | |
|----------------------------|--------------------------|--------------------------------------|------------|-------------|--------|
| SUBMITTED: | PDT | CHECKED BY: | PDT | DRAWN BY: | PDT |
| | Major Survey Team Leader | | | | |
| APPROVAL RECOMMENDED: | | DATE: | SHEET NO. | DRAWING NO. | XXX |
| | Chief, Geomatics Section | | 11/20/2012 | | 1 OF 4 |
| APPROVED: | | PREPARED UNDER THE DIRECTION OF | | | |
| Chief, Construction Branch | | JOHN K. BAKER | | | |
| | | LT. COLONEL, C.E., DISTRICT ENGINEER | | | |

CALIFORNIA
ALAMEDA COUNTY
RICHMOND INNER HARBOR
PREDRIDGE SURVEY
19 OCTOBER 2012
2, 5-6 & 16 NOVEMBER 2012

Sheet reference number
C4

MATCHLINE — SHEET 3