

RICHMOND INNER HARBOR
N.A.D 1983 FEET COORDINATES

CHANNEL L	EAST	NORTH
L1-1	6010314.28	2162197.51
L1-2	6010702.46	2161282.52
L1-3	6013071.04	2159051.01
L1-4	6013946.57	2158590.79
L1-5	6019811.99	2157565.50
L1-6	6022179.38	2157068.47
L1-7	6023175.24	2156977.58
L1-8	6024071.72	2157243.76
L1-9	6024244.63	2157572.06
L1-10	6023863.13	2159896.61
L1-11	6023718.07	2161814.06
L1-12	6023659.10	2161929.33
L1-13	6022203.51	2163156.86
L1-14	6022332.43	2163309.73
L1-15	6023871.49	2162011.81
L1-16	6024470.69	2161806.34
L1-17	6024629.99	2159700.65
L1-18	6024794.33	2158699.33
L1-19	6025096.44	2157620.99
L1-20	6025133.92	2156630.24
L1-21	6024797.57	2156256.37
L1-22	6023187.74	2156366.30
L1-23	6020299.03	2156972.78
L1-24	6016426.10	2157649.80
L1-25	6013280.69	2158029.15
L1-26	6009479.89	2161610.01

RICHMOND INNER HARBOR
N.A.D 1983 FEET COORDINATES

CENTERLINE L	EAST	NORTH
C1	6009732.76	2161788.08
C2	6010496.65	2161064.03
C3	6012865.31	2158832.61
C4	6013468.42	2158362.30
C5	6013908.41	2158274.42
C6	6016469.15	2157896.06
C7	6019768.94	2157319.23
C8	6020348.34	2157207.66
C9	6022130.07	2156833.59
C10	6023181.49	2156671.94
C11	6024434.64	2156750.06
C12	6024602.82	2156937.00
C13	6024670.53	2157596.52
C14	6024436.61	2158640.62
C15	6024272.27	2159641.94
C16	6024237.01	2159924.89
C17	6024094.38	2161810.20
C18	6023765.29	2161970.57
C19	6022267.77	2163233.06

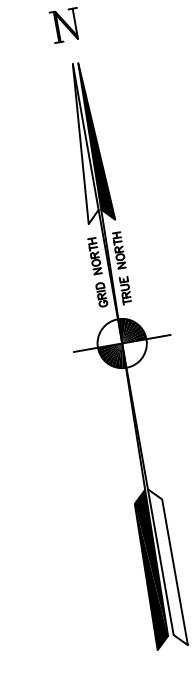

LEGEND:

—	-37'
—	-36'
—	-35'
—	-34'
—	-33'

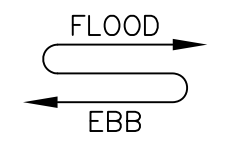

NOTES:
DRAWING NOT TO BE USED AS NAVIGATION. ONLY CHANNEL CONDITION AT DATE OF SURVEY. THE LOCATION OF ALL NAVIGATION AIDS ARE BASED ON INFORMATION PROVIDED BY THE U.S. COAST GUARD BUOY LOCATION REPRESENT THE POSITION OF THE SINKER ONLY.
SURVEYED BY THE CORPS OF ENGINEERS.
SOUNDINGS WERE TAKEN BY FATHOMETER AND ARE SHOWN TO THE NEAREST TENTH OF A FOOT.
SOUNDINGS ARE BASED ON THE DATUM OF MEAN LOWER LOW WATER AT THE LOCALITY.
PLANE GRID, BEARING AND COORDINATES ARE BASED ON THE STATE OF CALIFORNIA COORDINATE SYSTEM, LAMBERT CONFORMAL PROJECTION, ZONE III NAD 83, CALIFORNIA, AS DESCRIBED IN SPECIAL PUBLICATION NO. 253, PUBLISHED BY NATIONAL OCEAN SURVEY.
BASE MAPS WERE COMPILED BY PHOTOGAMMETRIC METHODS FROM AERIAL PHOTOGRAPHY FLOWN 10 AUGUST 1996.
THE PROJECT DEPTHS ARE AS FOLLOWS:
INNER HARBOR CHANNEL - 37 FEET.
CONTROL:
NOAA TIDE STATION: 841 4764
POOR-1 (PID: BBCT06) COE Disk - MLLW: 13.52 ft
POOR-2 (No PID) COE - MLLW: 13.92 ft
TIDE GAGE: "RI TO"
SOUTH CORNER OF FISHING PIER WEST OF S. HARBOR WAY
MLLW ELEV: 12.76 ft
POSITIONING:
RTK - BASE STATION @ POOR-1

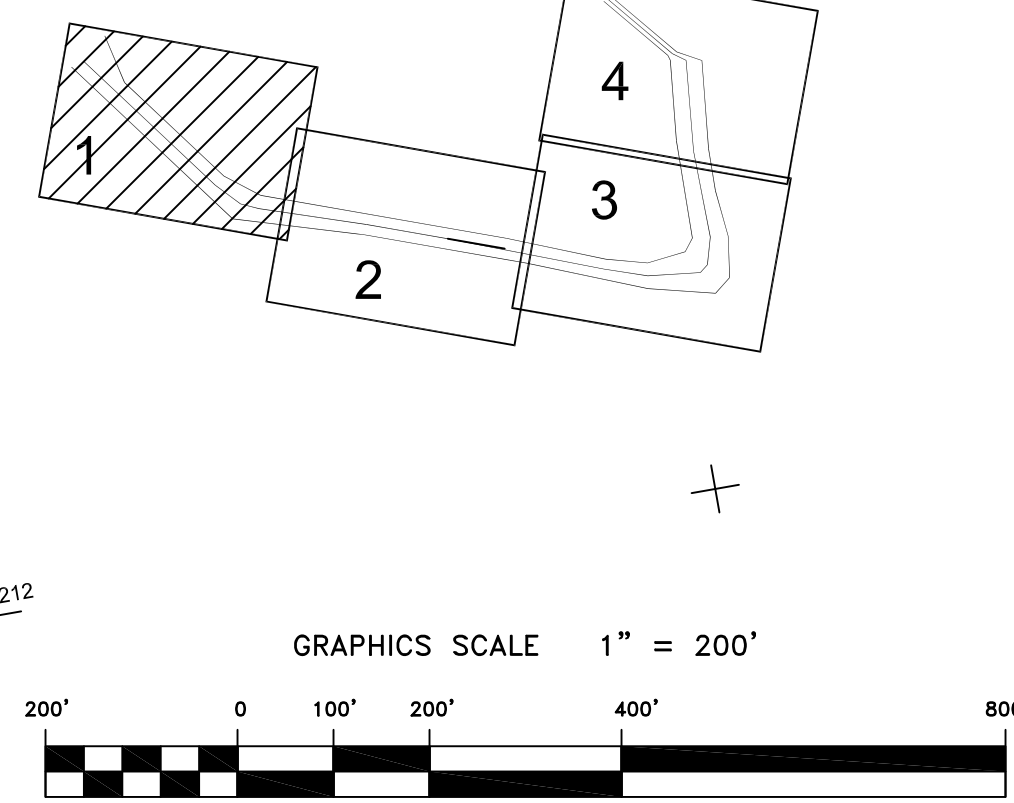

SUBMITTED: PDT
Hydro Survey Team Leader
APPROVAL RECOMMENDED:
DATE: 1/23/2015
DESIGNED BY: PDT
CHECKED BY: PDT
DRAWING NO.: 9
SHEET NO.: 1 OF 4
DATE: 1/23/2015
DRAWN BY: PDT
PDT
PREPARED UNDER THE DIRECTION OF
JOHN C. MORROW
LT. COLONEL, C.E., DISTRICT ENGINEER

CALIFORNIA
ALAMEDA COUNTY
RICHMOND INNER HARBOR
POST DREDGE SURVEY
REACH 1 - STA 12+00 TO 30+00
20 JANUARY 2015

Sheet reference number
C1

