

Mark	Description	Date	Appr.

DESIGNED BY:	PDT	CHECKED BY:	PDT
DATE:	01/1/2010	DRAWING NO.:	5
APPROVAL RECOMMENDED:	CHIEF, Technical Support Section	PREPARED UNDER THE DIRECTION OF:	LAURENCE M. FARRELL
APPROVED:	Chief, Construction Branch		
SUBMITTED:			
Hydro Survey Team Leader			
CALIFORNIA			
SAN PABLO BAY			
PINOLE SHOALS			
POSTDRIDGE SURVEY			
5, 7 & 13 JANUARY 2010			

CALIFORNIA
SAN PABLO BAY
PINOLE SHOALS
POSTDRIDGE SURVEY
5, 7 & 13 JANUARY 2010

Sheet reference number
C4

PRELIMINARY ISSUE
THIS PLAN ISSUED FOR
ADVANCE INFORMATION ONLY

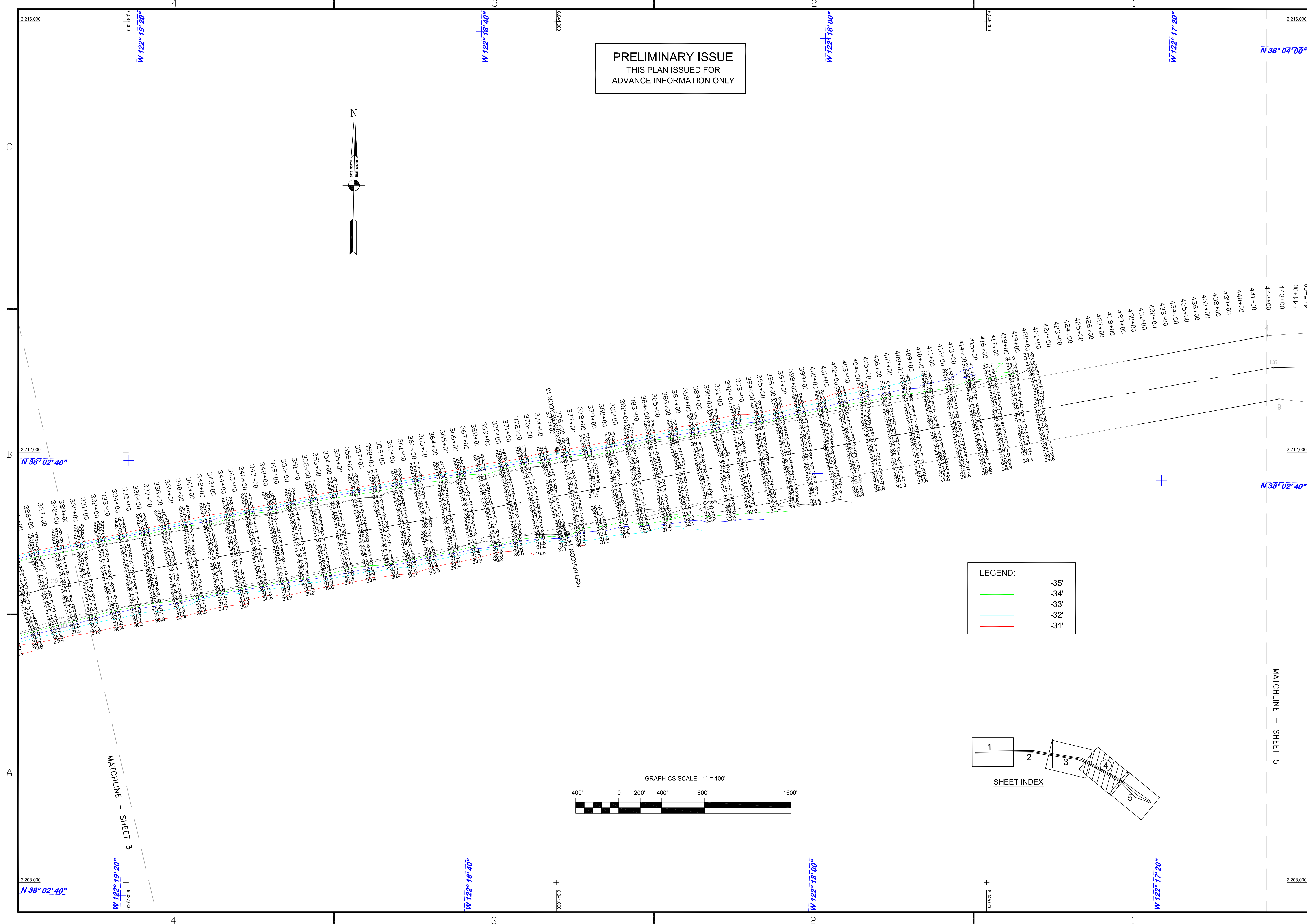

LEGEND:

(Red line)	-31'
(Blue line)	-32'
(Green line)	-33'
(Black line)	-35'

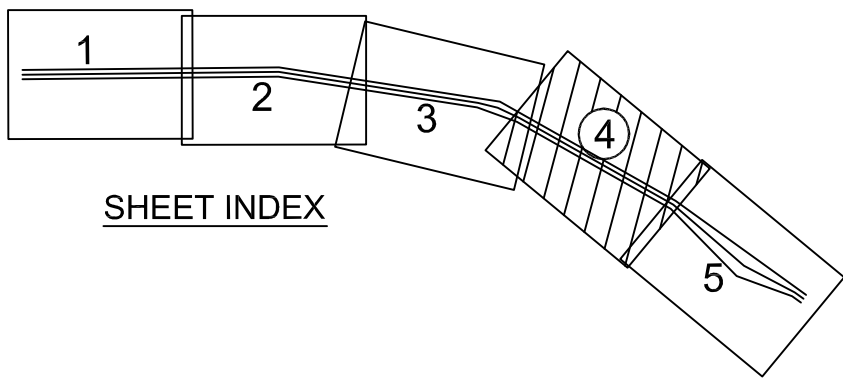

GRAPHICS SCALE 1" = 400'