

PRELIMINARY ISSUE
THIS PLAN ISSUED FOR
ADVANCE INFORMATION ONLY

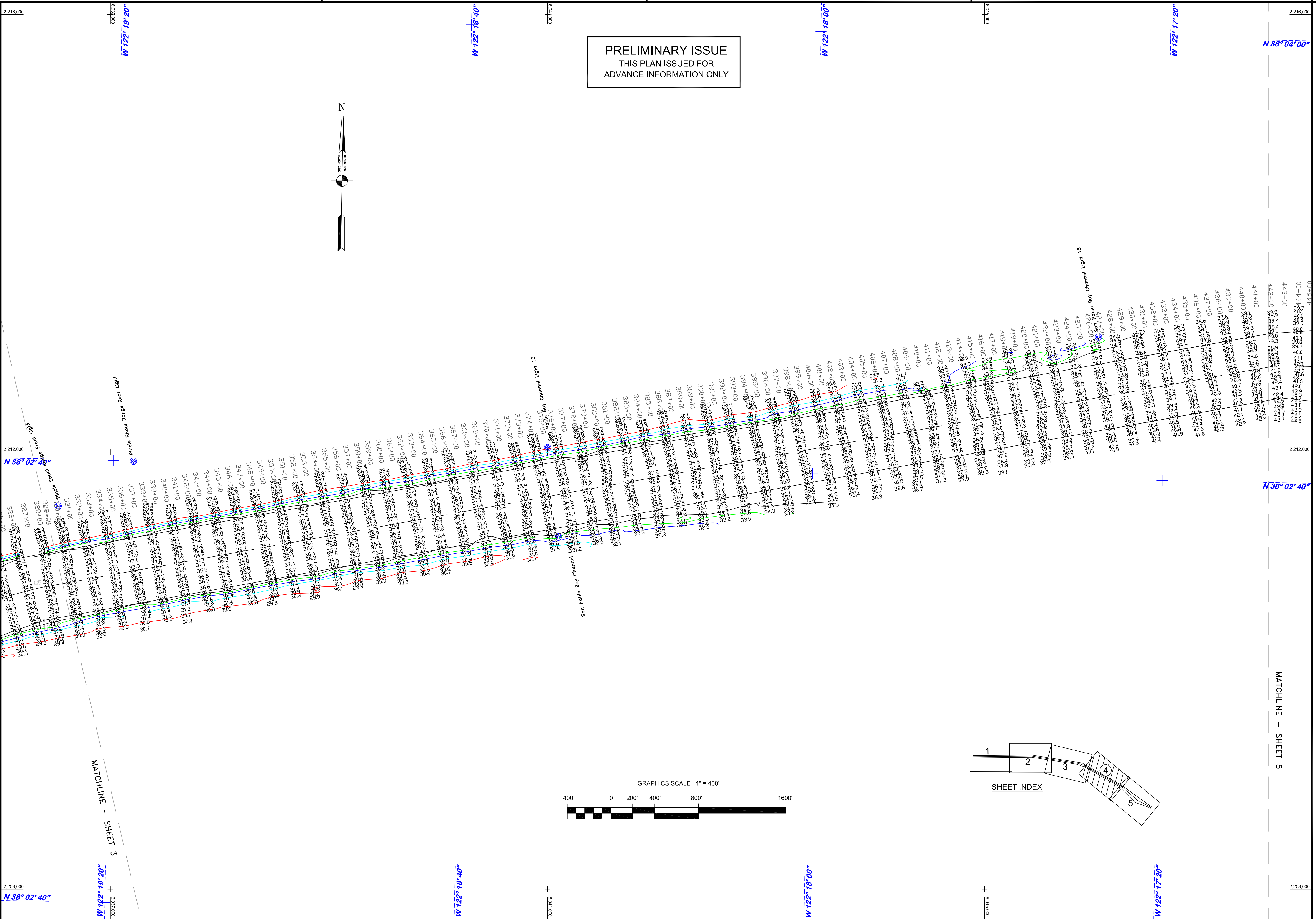
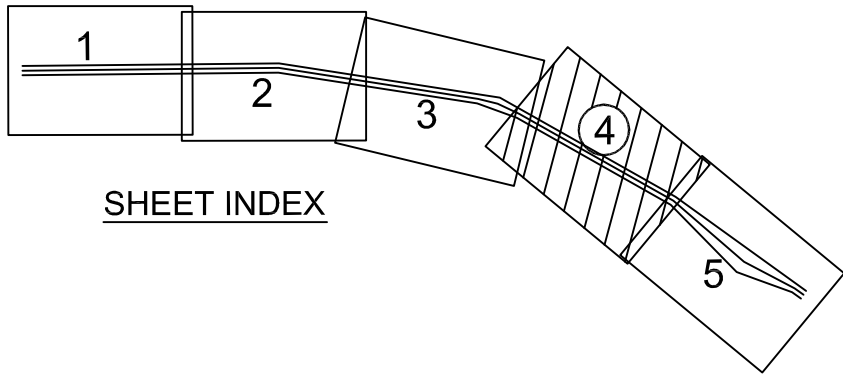
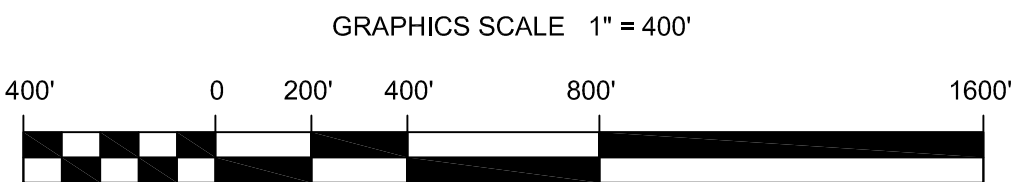
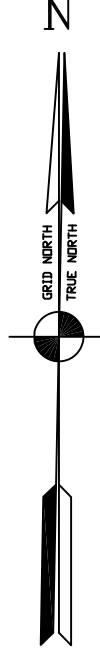

US Army Corps
of Engineers
San Francisco District
1455 Market Street
San Francisco, CA 94103

| Mark | Description | Date | Appr. |
|------|-------------|------|-------|
| | | | |
| | | | |
| | | | |
| | | | |
| | | | |
| | | | |
| | | | |
| | | | |
| | | | |
| | | | |
| | | | |

| | | | |
|-----------------------|--------------------------|------------------------------------|-------------|
| SUBMITTED: | PDT | DRAWN BY: | PDT |
| | Hydro Survey Team Leader | | |
| APPROVAL RECOMMENDED: | SHEET NO. | CHECKED BY: | DRAWING NO. |
| | 4 OF 5 | | 2 |
| | DATE: | DESIGNED BY: | PDT |
| | 01/5/2008 | LAURENCE M. FARRELL | |
| | | PREPARED UNDER THE DIRECTION OF | |
| | | LT. COLONEL C.E. DISTRICT ENGINEER | |
| | | | |
| | | | |
| | | | |

CALIFORNIA
SAN PABLO BAY
PINOLE SHOALS
CONDITION SURVEY
21-24 JANUARY 2010

Sheet reference
number
C4

MATCHLINE - SHEET 5

MATCHLINE - SHEET 3