

PRELIMINARY ISSUE
THIS PLAN ISSUED FOR
ADVANCE INFORMATION ONLY

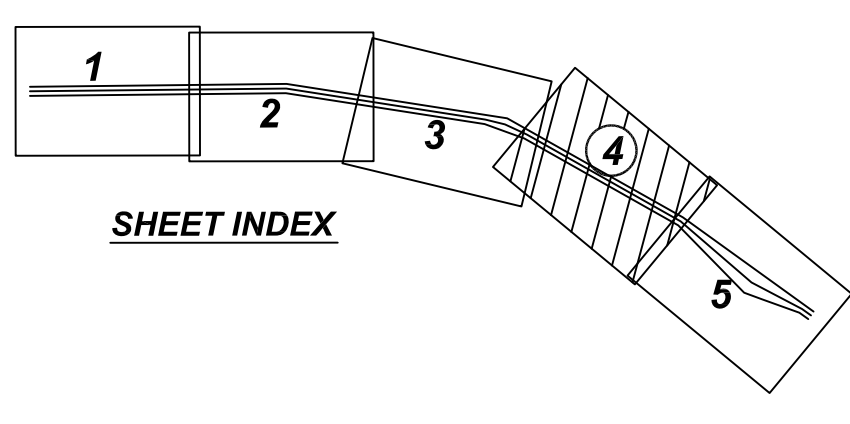
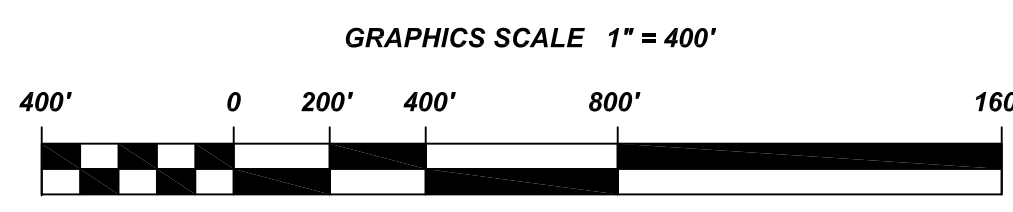
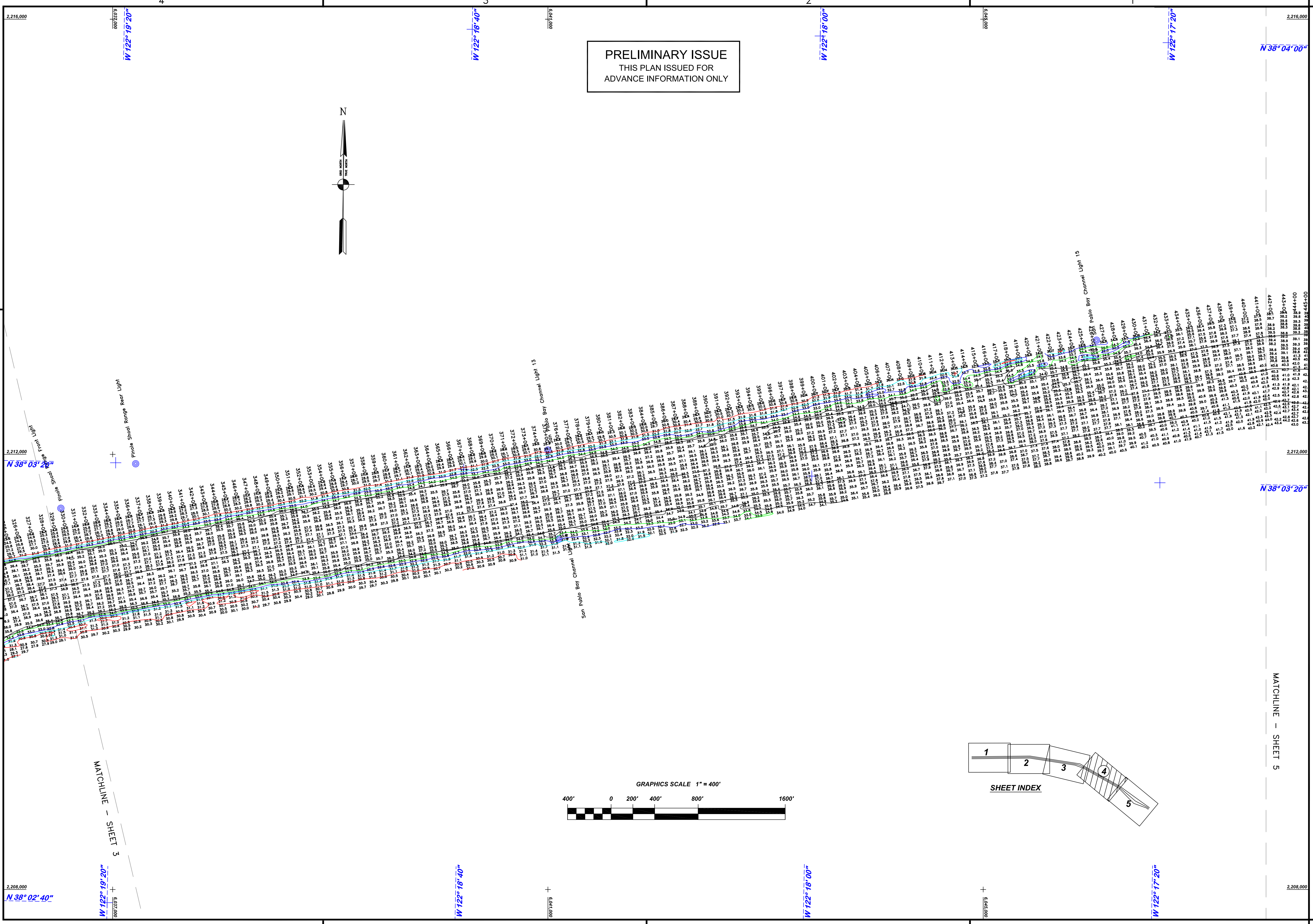
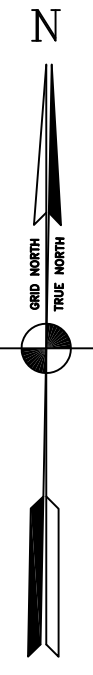

US Army Corps of Engineers
San Francisco District
1455 Market Street
San Francisco, CA 94103

Mark	Date	Appr.

SUBMITTED:	PDT	CHECKED BY:	DRAWN BY:
	Hydro Survey Team Leader	PDT	PDT
APPROVAL RECOMMENDED:	DATE:	SHEET NO.	DRAWING NO.
		10/28/2013	3 OF 5
APPROVED:			
Chief, Hydro Survey Section		JOHN K. BAKER	
Chief, Construction Branch		LT. COLONEL, C.E., DISTRICT ENGINEER	

CALIFORNIA
SAN PABLO BAY
**PINOLE SHOALS
POSTDREDGE SURVEY**
6-9, 25 SEPTEMBER 2013

Sheet reference number
C4