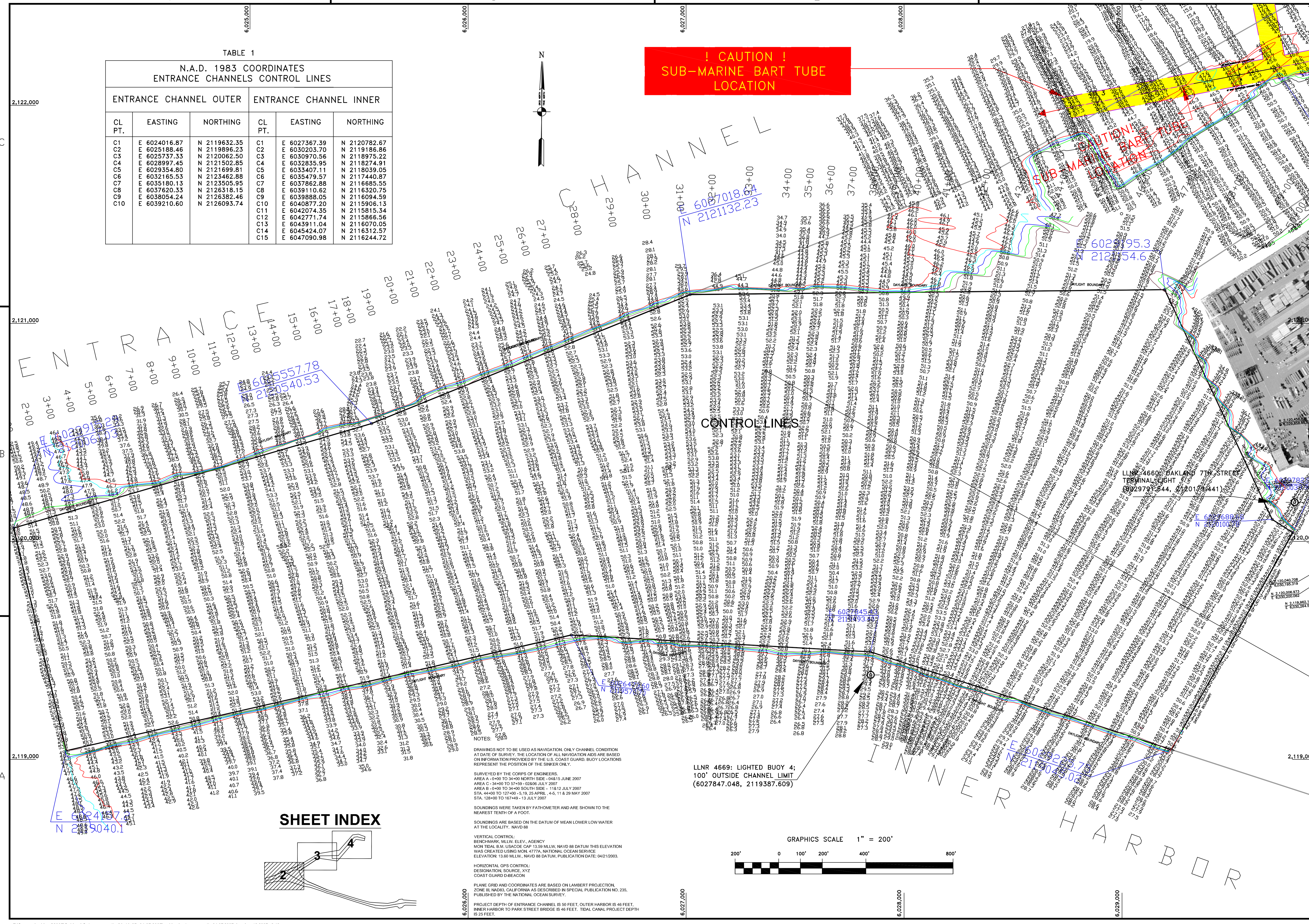

TABLE 1
N.A.D. 1983 COORDINATES
ENTRANCE CHANNELS CONTROL LINES

ENTRANCE CHANNEL OUTER			ENTRANCE CHANNEL INNER		
CL PT.	EASTING	NORTHING	CL PT.	EASTING	NORTHING
C1	E 6024016.87	N 2119632.35	C1	E 6027367.39	N 2120782.67
C2	E 6025183.46	N 2119896.23	C2	E 6030203.70	N 2119156.86
C3	E 6025737.33	N 2120062.50	C3	E 6030970.56	N 2118975.22
C4	E 6028997.45	N 2121502.85	C4	E 6032835.95	N 2118274.91
C5	E 6029354.80	N 2121699.81	C5	E 6033407.11	N 2118039.05
C6	E 6032165.53	N 2123462.88	C6	E 6035479.57	N 2117440.87
C7	E 6035180.13	N 2123505.95	C7	E 6037862.88	N 2116685.55
C8	E 6037620.33	N 2126318.15	C8	E 6039110.62	N 2116320.75
C9	E 6038054.24	N 2126382.46	C9	E 6039888.05	N 2116094.59
C10	E 6039210.60	N 2126093.74	C10	E 6040877.20	N 2115906.13
			C11	E 6042074.35	N 2115815.34
			C12	E 6042771.74	N 2115866.56
			C13	E 6043911.04	N 2116070.05
			C14	E 6045424.07	N 2116312.57
			C15	E 6047090.98	N 2116244.72



**! CAUTION !
SUB-MARINE BART TUBE
LOCATION**

CONTROL LINES

LLNR 4669: LIGHTED BUOY 4;
100' OUTSIDE CHANNEL LIMIT
(6027847.048, 2119357.609)

NOTES:
DRAWINGS NOT TO BE USED AS NAVIGATION. ONLY CHANNEL CONDITION AT DATE OF SURVEY. THE LOCATION OF ALL NAVIGATION AIDS ARE BASED ON INFORMATION PROVIDED BY THE U.S. COAST GUARD. BUOY LOCATIONS REPRESENT THE POSITION OF THE SINKER ONLY.

SURVEYED BY THE CORPS OF ENGINEERS.
AREA A - 0+00 TO 34+00 NORTH SIDE - 04/15 JUNE 2007
AREA C - 34+00 TO 37+00 SOUTH SIDE - 02/06 JULY 2007
AREA B - 0+00 TO 34+00 SOUTH SIDE - 11/12 JULY 2007
STA. 44+00 TO 127+00 - 5, 19, 25 APRIL - 4, 5, 11 & 29 MAY 2007
STA. 128+00 TO 167+00 - 13 JULY 2007

SOUNDINGS WERE TAKEN BY FATHOMETER AND ARE SHOWN TO THE NEAREST TENTH OF A FOOT.

SOUNDINGS ARE BASED ON THE DATUM OF MEAN LOWER LOW WATER AT THE LOCALITY. NAVD 88

VERTICAL CONTROL:
BENCHMARK: MLLW, ELEV., AGENCY
MON TIDAL B.M. USACOE CAP 13.99 MLLW, NAVD 88 DATUM, THIS ELEVATION WAS CREATED USING MON TIDAL B.M. NATIONAL OCEAN SERVICE ELEVATION: 13.60 MLLW, NAVD 88 DATUM, PUBLICATION DATE: 04/12/2003.

HORIZONTAL GPS CONTROL:
DESIGNATION, SOURCE, XYZ
COAST GUARD D-8EACON

PLANE GRID AND COORDINATES ARE BASED ON LAMBERT PROJECTION, ZONE III, NAD 83, CALIFORNIA AS DESCRIBED IN SPECIAL PUBLICATION NO. 235, PUBLISHED BY THE NATIONAL OCEAN SURVEY.

PROJECT DEPTH OF ENTRANCE CHANNEL IS 50 FEET, OUTER HARBOR IS 46 FEET, INNER HARBOR TO PARK STREET BRIDGE IS 46 FEET. TIDAL CANAL PROJECT DEPTH IS 25 FEET.

SHEET INDEX

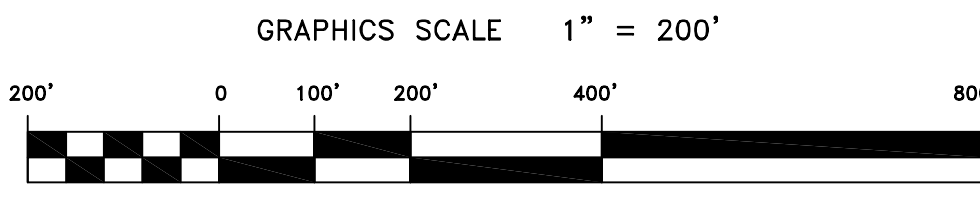
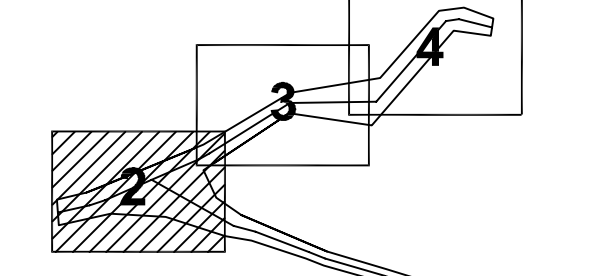

US Army Corps of Engineers
San Francisco District
1455 Market Street
San Francisco, CA 94103

DESIGNED BY:	CHECKED BY:	DRAWN BY:
MC	TYW	EWC
APPROVAL RECOMMENDED:	SHEET NO.	DRAWING NO.
	2 OF 3	2
DATE:	07/18/2007	362
CHIEF, Technical Support Section:	PREPARED UNDER THE DIRECTION OF	
APPROVED:	CRAIG W. KILEY	
CHIEF, Construction Branch	LT. COLONEL, C.E., DISTRICT ENGINEER	

SUBMITTED:	MC	DESIGNED BY:	CHECKED BY:	DRAWN BY:
Info Survey Section			TYW	EWC
APPROVAL RECOMMENDED:		SHEET NO.	2 OF 3	2
DATE:		07/18/2007		362
CHIEF, Technical Support Section:		PREPARED UNDER THE DIRECTION OF		
APPROVED:		CRAIG W. KILEY		
CHIEF, Construction Branch		LT. COLONEL, C.E., DISTRICT ENGINEER		

CALIFORNIA
ALAMEDA COUNTY
OAKLAND OUTER HARBOR
POSTEDGE SURVEY
5, 19, 25 APRIL, 4-5, 11 & 29 MAY 2007
4, & 15 JUNE AND
2, 6, 11, 12 & 13 JULY 2007

Sheet
reference
number
C2