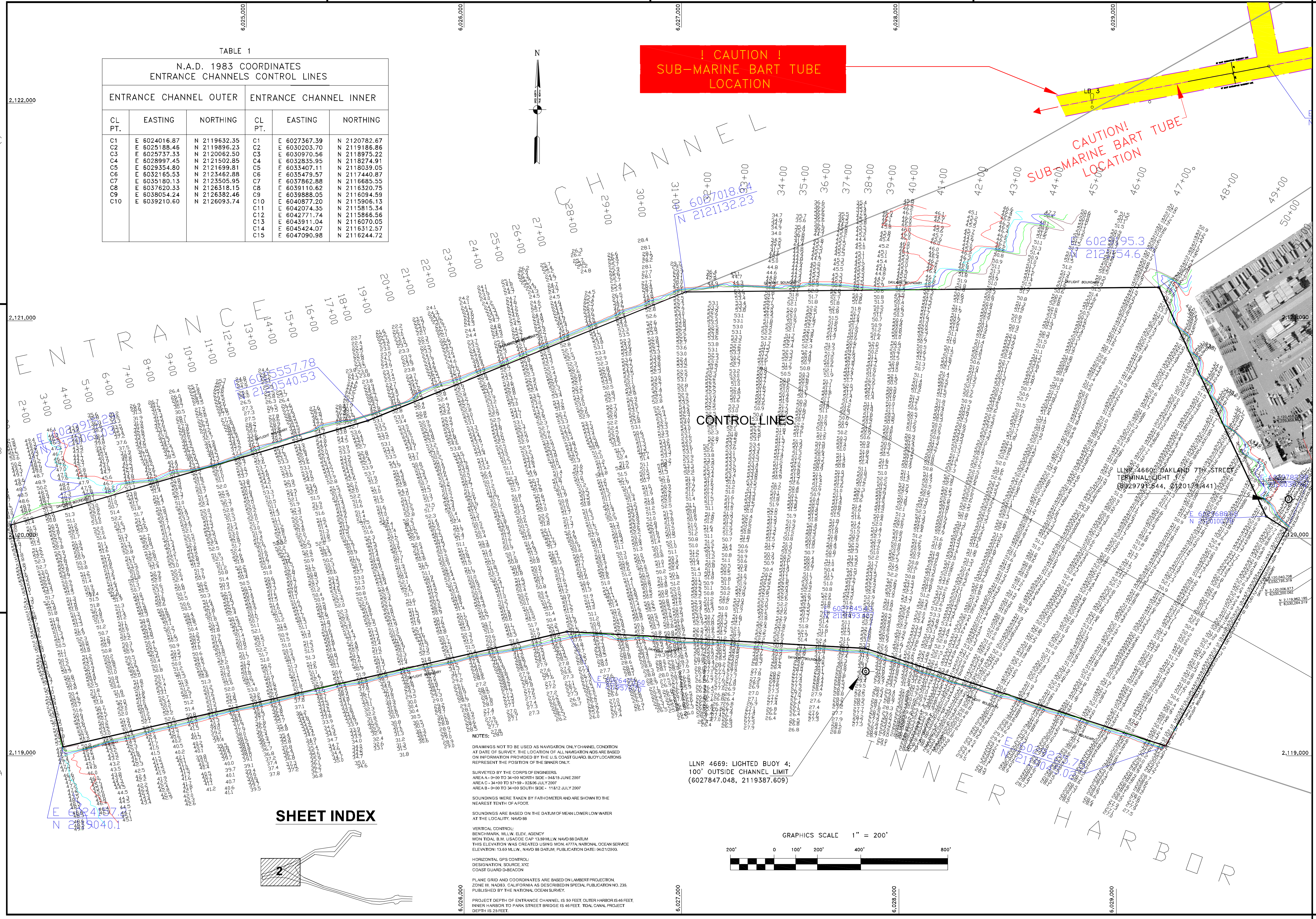

TABLE 1  
N.A.D. 1983 COORDINATES  
ENTRANCE CHANNELS CONTROL LINES

ENTRANCE CHANNEL OUTER			ENTRANCE CHANNEL INNER		
CL PT.	EASTING	NORTHING	CL PT.	EASTING	NORTHING
C1	E 6024016.87	N 2119632.35	C1	E 6027367.39	N 2120782.67
C2	E 6025188.46	N 2119896.23	C2	E 6030203.70	N 2119186.86
C3	E 6025737.33	N 2120062.50	C3	E 6030970.56	N 2118975.22
C4	E 6028997.45	N 2121502.35	C4	E 6032835.95	N 2118274.91
C5	E 6029354.80	N 2121699.81	C5	E 6033407.11	N 2118039.05
C6	E 6032165.53	N 2123462.88	C6	E 6035479.57	N 2117440.87
C7	E 6035180.13	N 2123505.95	C7	E 6037862.88	N 2116685.55
C8	E 6037620.33	N 2126318.15	C8	E 6039110.62	N 2116320.75
C9	E 6038054.24	N 2126382.46	C9	E 6039888.05	N 2116094.59
C10	E 6039210.60	N 2126093.74	C10	E 6040877.20	N 2115906.13
C11			C11	E 6042074.35	N 2115815.34
C12			C12	E 6042771.74	N 2115866.56
C13			C13	E 6043311.04	N 2116070.03
C14			C14	E 6045424.07	N 2116312.57
C15			C15	E 6047090.98	N 2116244.72

**! CAUTION !  
SUB-MARINE BART TUBE  
LOCATION**

**CAUTION!  
SUB-MARINE BART TUBE  
LOCATION**



CONTROL LINES

LLNR 4669: LIGHTED BUOY 4;  
100' OUTSIDE CHANNEL LIMIT  
(6027847.048, 2119387.609)

**NOTES:**

DRAWINGS NOT TO BE USED AS NAVIGATION ONLY CHANNEL CONDITION AT DATE OF SURVEY. THE LOCATION OF ALL NAVIGATION AIDS ARE BASED ON INFORMATION PROVIDED BY THE U.S. COAST GUARD BUOY LOCATIONS REPRESENT THE POSITION OF THE SINKER ONLY.

SURVEYED BY THE CORPS OF ENGINEERS.  
AREA A - 0+00 TO 34+00 NORTH SIDE - 04/15 JUNE 2007  
AREA C - 34+00 TO 37+00 - 03/09 JULY 2007  
AREA B - 0+00 TO 34+00 SOUTH SIDE - 11/12 JULY 2007

SOUNDINGS WERE TAKEN BY FATHOMETER AND ARE SHOWN TO THE NEAREST TENTH OF A FOOT.

SOUNDINGS ARE BASED ON THE DATUM OF MEAN LOWER LOW WATER AT THE LOCALITY, NAVD 88

VERTICAL CONTROL:  
BENCHMARK MLLW, ELEV. AGENCY  
MON TIDAL B.M. USACDE CAP 13.59 MLLW NAVD 88 DATUM  
THIS ELEVATION WAS CREATED USING MON. 4774 NATIONAL OCEAN SERVICE ELEVATION: 13.60 MLLW, NAVD 88 DATUM, PUBLICATION DATE: 04/21/2003.

HORIZONTAL GPS CONTROL:  
DESIGNATION, SOURCE, XYZ  
COAST GUARD D-BEACON

PLANE GRID AND COORDINATES ARE BASED ON LAMBERT PROJECTION, ZONE III, NAD83, CALIFORNIA AS DESCRIBED IN SPECIAL PUBLICATION NO. 235, PUBLISHED BY THE NATIONAL OCEAN SURVEY.

PROJECT DEPTH OF ENTRANCE CHANNEL IS 50 FEET OUTER HARBOR IS 46 FEET INNER HARBOR TO PARK STREET BRIDGE IS 46 FEET. TIDAL CANAL PROJECT DEPTH IS 25 FEET.

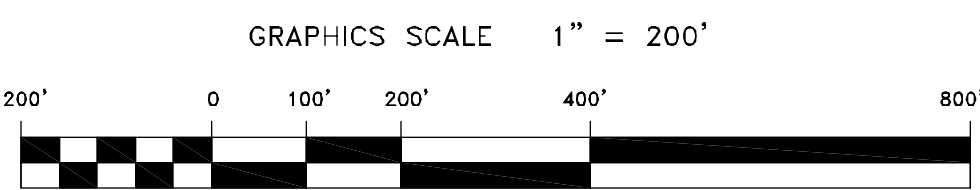

**SHEET INDEX**

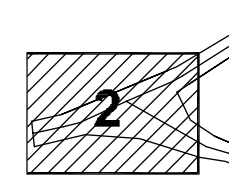

US Army Corps of Engineers  
San Francisco District  
1455 Market Street  
San Francisco, CA 94103

DESIGNED BY:	MC	CHECKED BY:	TJW	DRAWN BY:	EMC
DATE:	07/18/2007	SHEET NO.:	2 OF 3	DRAWING NO.:	2
APPROVED:	Craig W. Kiley	APPROVED:	Craig W. Kiley	APPROVED:	362
CHIEF, Technical Support Section		CHIEF, Construction Branch		PREPARED UNDER THE DIRECTION OF	
				CRAIG W. KILEY	
				LT. COLONEL, C.E., DISTRICT ENGINEER	

CALIFORNIA  
ALAMEDA COUNTY  
OAKLAND OUTER HARBOR  
POSTREDGE SURVEY  
4 & 15 JUNE AND  
2, 6 11 & 12 JULY 2007

Sheet reference number  
**C2**