

PRELIMINARY ISSUE
 THIS PLAN ISSUED FOR
 ADVANCE INFORMATION ONLY

Mark	Description	Date	Appr.

DESIGNED BY:	CHECKED BY:	DRAWN BY:
PDT	PDT	PDT
Hydro Survey Team Leader	Hydro Survey Team Leader	Hydro Survey Team Leader
APPROVAL RECOMMENDED:	DATE:	SHEET NO.
Chief, Technical Support Section	1/21/2011	6 OF 8
APPROVED:	PREPARED UNDER THE DIRECTION OF	2
Chief, Construction Branch	TORREY A. DICIRO	2
	LT. COLONEL, C.E., DISTRICT ENGINEER	XXX

ALAMEDA COUNTY
 OAKLAND HARBOR
 INNER HARBOR
 POSTREDGE SURVEY
 20 & 21 JANUARY 2011

Sheet reference number
C6

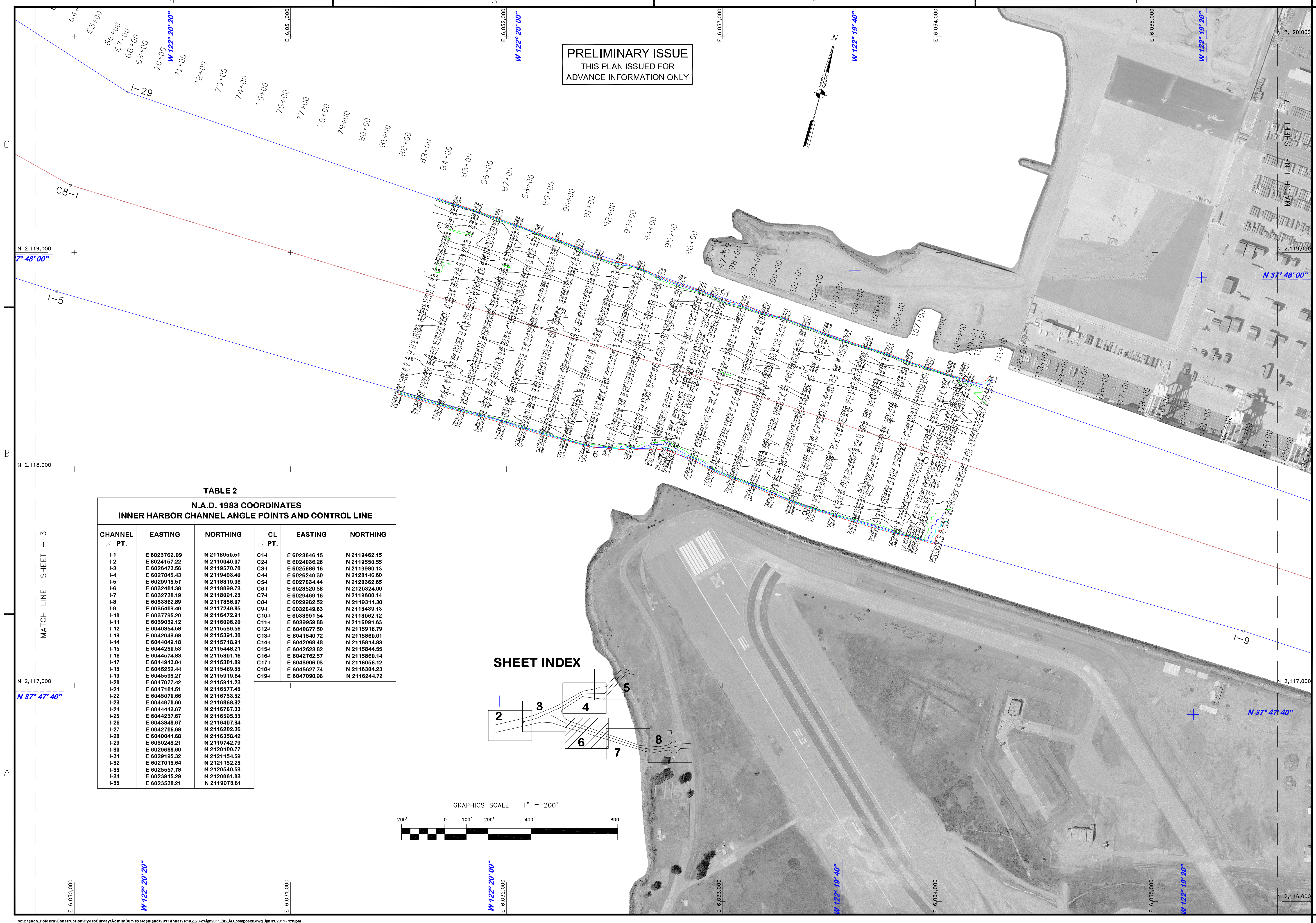

TABLE 2
 N.A.D. 1983 COORDINATES
 INNER HARBOR CHANNEL ANGLE POINTS AND CONTROL LINE

CHANNEL ∠ PT.	EASTING	NORTHING	CL ∠ PT.	EASTING	NORTHING
I-1	E 6023762.09	N 2118950.51	C1-1	E 6023646.15	N 2119462.15
I-2	E 6024157.22	N 2119040.07	C2-1	E 6024036.26	N 2119550.55
I-3	E 6025473.56	N 2119570.70	C3-1	E 6025686.16	N 2119980.13
I-4	E 6027845.43	N 2119493.40	C4-1	E 6026240.30	N 2120146.80
I-5	E 6029918.57	N 2118819.96	C5-1	E 6027834.44	N 2120362.65
I-6	E 6032404.38	N 2118099.73	C6-1	E 6028520.38	N 2120324.00
I-7	E 6032730.19	N 2118091.23	C7-1	E 6029469.16	N 2119600.14
I-8	E 6033362.89	N 2117836.07	C8-1	E 6029982.52	N 2119311.30
I-9	E 6035409.49	N 2117249.85	C9-1	E 6032849.63	N 2118439.13
I-10	E 6037795.20	N 2116472.91	C10-1	E 6033991.54	N 2118062.12
I-11	E 6039039.12	N 2116096.20	C11-1	E 6039959.88	N 2116091.63
I-12	E 6040654.58	N 2115539.56	C12-1	E 6040877.50	N 2115916.79
I-13	E 6042043.88	N 2115391.38	C13-1	E 6041540.72	N 2115860.01
I-14	E 6044049.18	N 2115718.91	C14-1	E 6042068.48	N 2115814.83
I-15	E 6044280.53	N 2115448.21	C15-1	E 6042523.82	N 2115844.55
I-16	E 6044574.83	N 2115301.16	C16-1	E 6042762.57	N 2115860.14
I-17	E 6044943.04	N 2115301.09	C17-1	E 6043906.03	N 2116056.12
I-18	E 6045252.44	N 2115469.88	C18-1	E 6045627.74	N 2116304.23
I-19	E 6045598.27	N 2115919.64	C19-1	E 6047090.98	N 2116244.72
I-20	E 6047077.42	N 2115911.23			
I-21	E 6047104.51	N 2116577.48			
I-22	E 6045070.86	N 2116733.32			
I-23	E 6044970.66	N 2116868.32			
I-24	E 6044443.67	N 2116787.33			
I-25	E 6044237.67	N 2116595.33			
I-26	E 6043848.67	N 2116407.34			
I-27	E 6042706.68	N 2116202.36			
I-28	E 6040041.68	N 2116358.42			
I-29	E 6030243.21	N 2119742.79			
I-30	E 6029688.69	N 2120100.77			
I-31	E 6029195.32	N 2121154.59			
I-32	E 6027018.64	N 2121132.23			
I-33	E 6025557.78	N 2120540.53			
I-34	E 6023915.29	N 2120061.03			
I-35	E 6023530.21	N 2119973.81			

SHEET INDEX

