

**PRELIMINARY ISSUE**  
THIS PLAN ISSUED FOR  
ADVANCE INFORMATION ONLY

**TABLE 1**  
**N.A.D. 1983 COORDINATES**  
**OUTER HARBOR CHANNEL ANGLE POINTS AND CONTROL LINE**

CHANNEL PT.	EASTING	NORTHING	CL PT.	EASTING	NORTHING
O-1	E 6020245.90	N 2118153.46	C1-O	E 6024016.87	N 2119632.35
O-2	E 6023762.11	N 2118950.43	C2-O	E 6025188.46	N 2119896.23
O-3	E 6026473.56	N 2119570.70	C3-O	E 6025737.33	N 2120062.50
O-4	E 6029195.32	N 2121154.59	C4-O	E 6028997.45	N 2121502.85
O-5	E 6032145.86	N 2123096.60	C5-O	E 60329354.80	N 2121699.81
O-6	E 6035035.47	N 2126912.23	C6-O	E 6032165.53	N 2123462.88
O-7	E 6038502.15	N 2126685.68	C7-O	E 6035180.13	N 2123505.95
O-8	E 6038225.45	N 2126792.32	C8-O	E 6037620.33	N 2126318.15
O-9	E 6037357.62	N 2126663.70	C9-O	E 6038054.24	N 2126392.46
O-10	E 6035435.94	N 2124447.60	C10-O	E 6039210.60	N 2126093.74
O-11	E 6034521.88	N 2124383.85			
O-12	E 6034015.75	N 2124177.44			
O-13	E 6032185.18	N 2123829.00			
O-14	E 6028402.05	N 2121692.56			
O-15	E 6027018.64	N 2121132.23			
O-16	E 6025557.78	N 2120540.53			
O-17	E 6023530.21	N 2119973.82			
O-18	E 6020014.00	N 2119177.46			

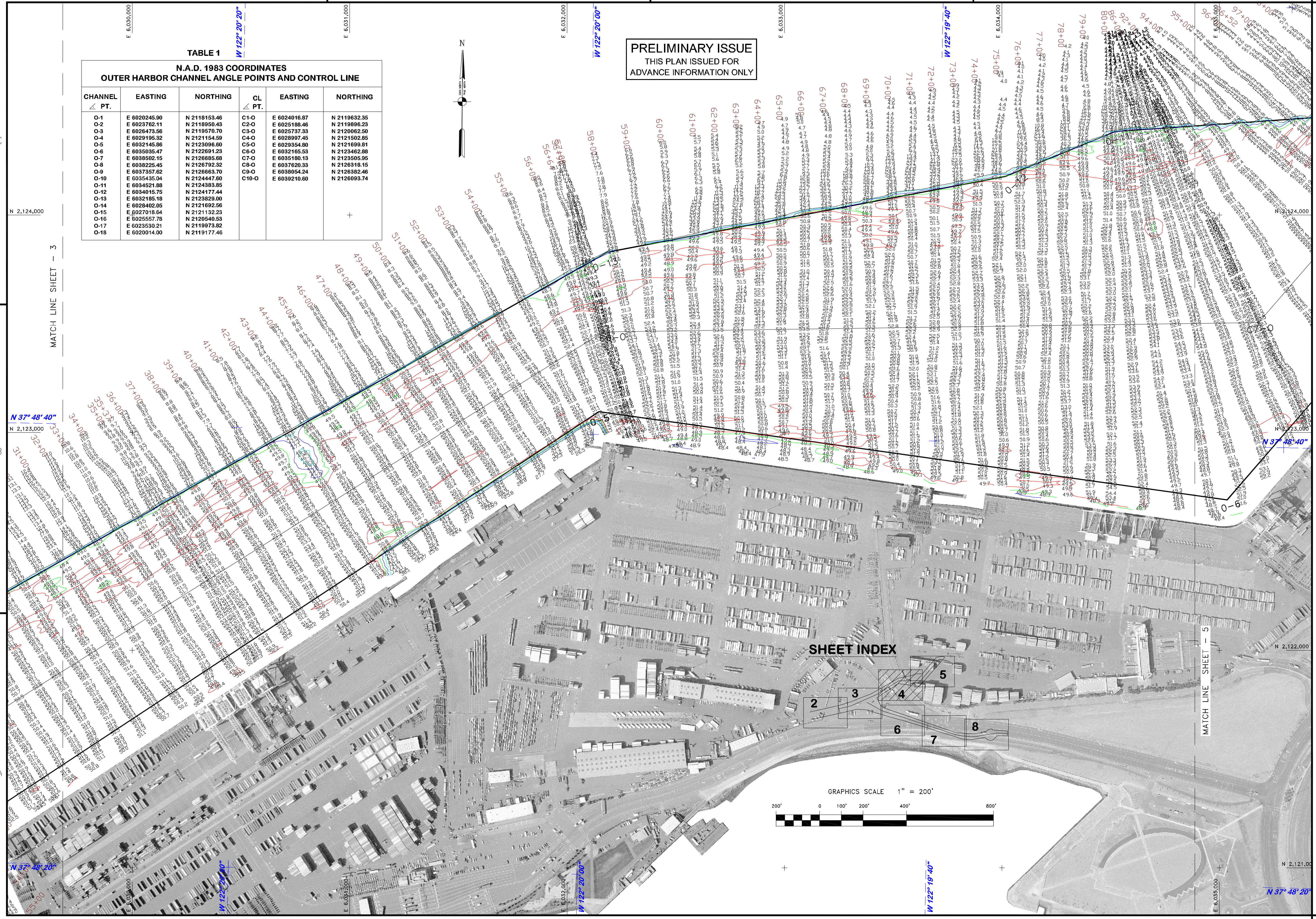

US Army Corps  
of Engineers  
San Francisco District  
455 Market Street  
San Francisco, CA 94103

Mark	Description	Date	Appr.

DESIGNED BY:	CHECKED BY:	DRAWN BY:
PDT	PDT	PDT
DATE:	DATE:	DATE:
6/30/2009	4 OF 8	2
SHEET NO. DRAWING NO. XXX		
PREPARED UNDER THE DIRECTION OF LAURENCE M. FARRELL LT. COLONEL, C.E., DISTRICT ENGINEER		

ALAMEDA COUNTY CALIFORNIA  
**OAKLAND HARBOR**  
OUTER HARBOR  
PREDREDGE SURVEY  
22 - 24 JUNE 2009

Sheet  
reference  
number  
**C4**