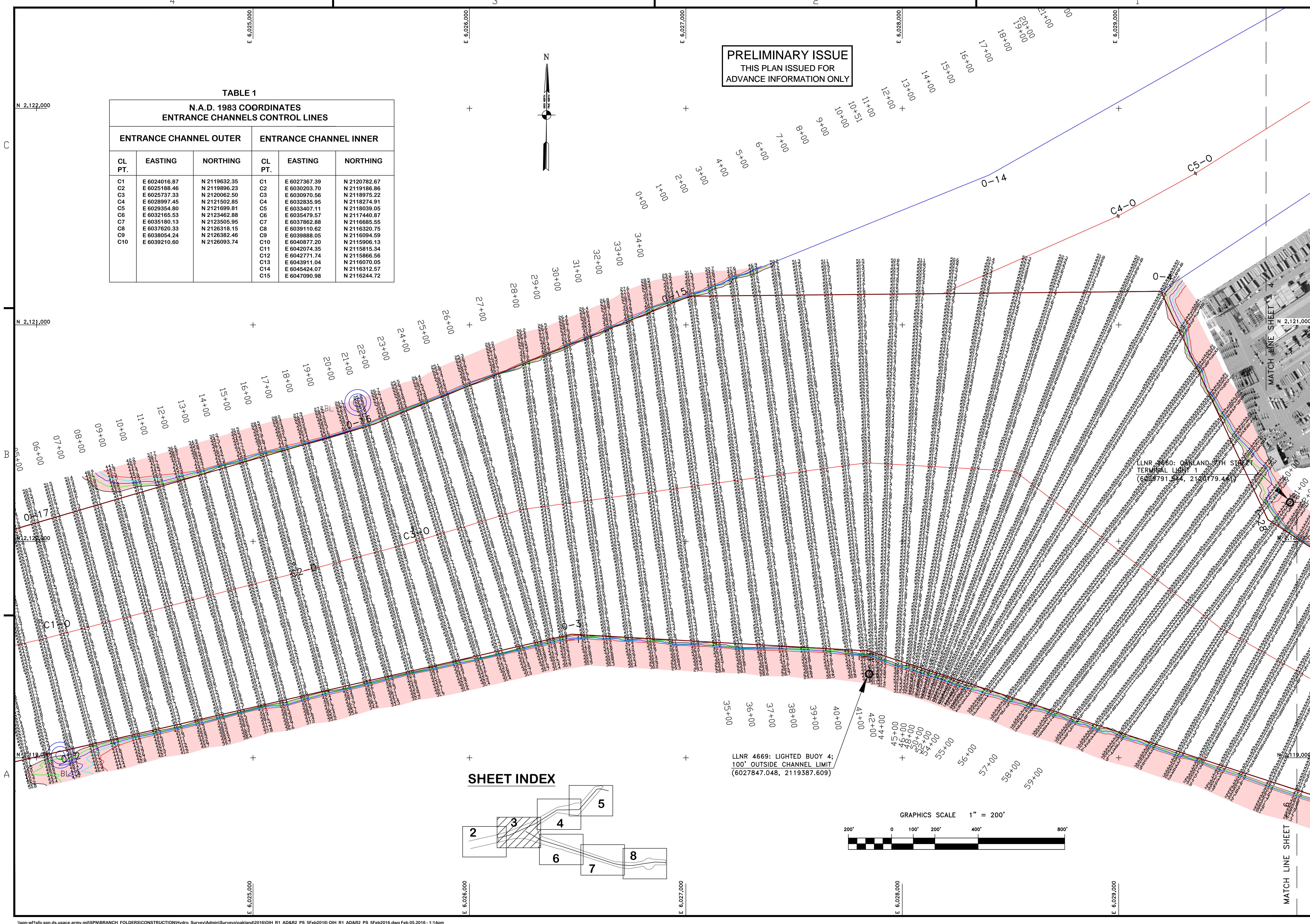

TABLE 1
N.A.D. 1983 COORDINATES
ENTRANCE CHANNELS CONTROL LINES

ENTRANCE CHANNEL OUTER			ENTRANCE CHANNEL INNER		
CL PT.	EASTING	NORTHING	CL PT.	EASTING	NORTHING
C1	E 6024016.87	N 2119632.35	C1	E 6027367.39	N 2120782.67
C2	E 6025188.46	N 2119896.23	C2	E 6030203.70	N 2119186.86
C3	E 6025737.33	N 2120062.50	C3	E 6030970.56	N 2118975.22
C4	E 6028997.45	N 2121502.85	C4	E 6032835.95	N 2118274.91
C5	E 6029354.80	N 2121699.81	C5	E 6033407.11	N 2118039.05
C6	E 6032165.53	N 2123462.88	C6	E 6035479.57	N 2117440.87
C7	E 6035180.13	N 2123505.95	C7	E 6037862.88	N 2116685.55
C8	E 6037620.33	N 2126318.15	C8	E 6039110.62	N 2116320.75
C9	E 6038054.24	N 2128382.46	C9	E 6039988.05	N 2116094.59
C10	E 6039210.60	N 2126093.74	C10	E 6040877.20	N 2115906.13
			C11	E 6042074.35	N 2115815.34
			C12	E 6042771.74	N 2115866.56
			C13	E 6043911.04	N 2116070.05
			C14	E 6045424.07	N 2116312.57
			C15	E 6047090.98	N 2116244.72

PRELIMINARY ISSUE
THIS PLAN ISSUED FOR
ADVANCE INFORMATION ONLY



SHEET INDEX

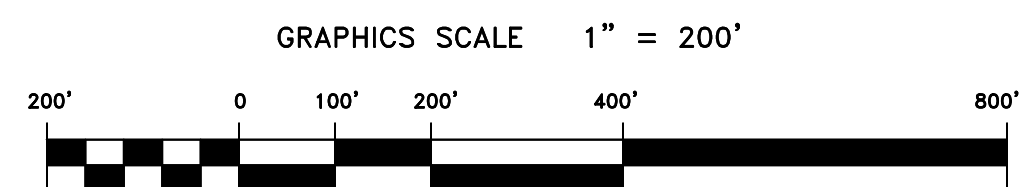
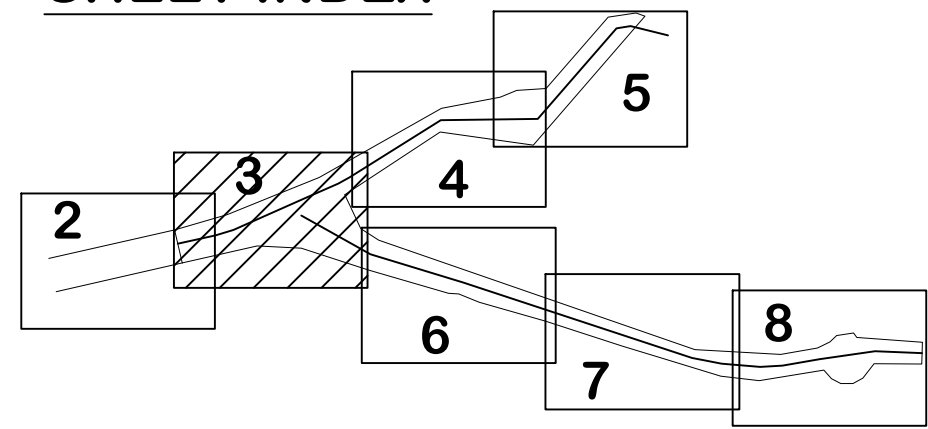

LLNR 4660: OAKLAND BAY STREET
TERMINAL LIGHT 1
(602791.544, 2120179.443)

LLNR 4669: LIGHTED BUOY 4;
100' OUTSIDE CHANNEL LIMIT
(6027847.048, 2119387.609)

US Army Corps
of Engineers
San Francisco District
1455 Market Street
San Francisco, CA 94103

Mark	Description	Date	Appr.

DESIGNED BY:	PDT	CHECKED BY:	PDT	DRAWN BY:	PDT
DATE:	2/5/2016	DATE:	2/5/2016	DATE:	2/5/2016
APPROVAL RECOMMENDED:	CHM, Technical Support Section	APPROVED:	CHM, Technical Support Section	APPROVAL RECOMMENDED:	CHM, Technical Support Section
PREPARED UNDER THE DIRECTION OF			JOHN C. MORROW		
PREPARED BY:			LT. COLONEL, C.E., DISTRICT ENGINEER		

ALAMEDA COUNTY CALIFORNIA
OAKLAND HARBOR
REACH 1 POSTREDGE SURVEY COMPOSITE
26 JAN & 3 FEB 2016
REACH 2 PROGRESS SURVEY COMPOSITE
23 DEC 2015 & 29 JAN 2016

Sheet reference
number
C3