

--	--	--	--

Mark	Description	Date	Aspr.

DESIGNED BY:	PDT	CHECKED BY:	PDT	DRAWN BY:	PDT
DATE:	3/31/2016	SHEET NO.:	6 OF 8	DRAWING NO.:	2
APPROVAL RECOMMENDED:		PREPARED UNDER THE DIRECTION OF:	JOHN C. MORROW		
APPROVED:			LT. COLONEL, C.E., DISTRICT ENGINEER		

ALAMEDA COUNTY CALIFORNIA
OAKLAND HARBOR
INNER HARBOR
POSTSTOREGE SURVEY
REACH 3
25-30 MARCH 2016

Sheet reference number
C6

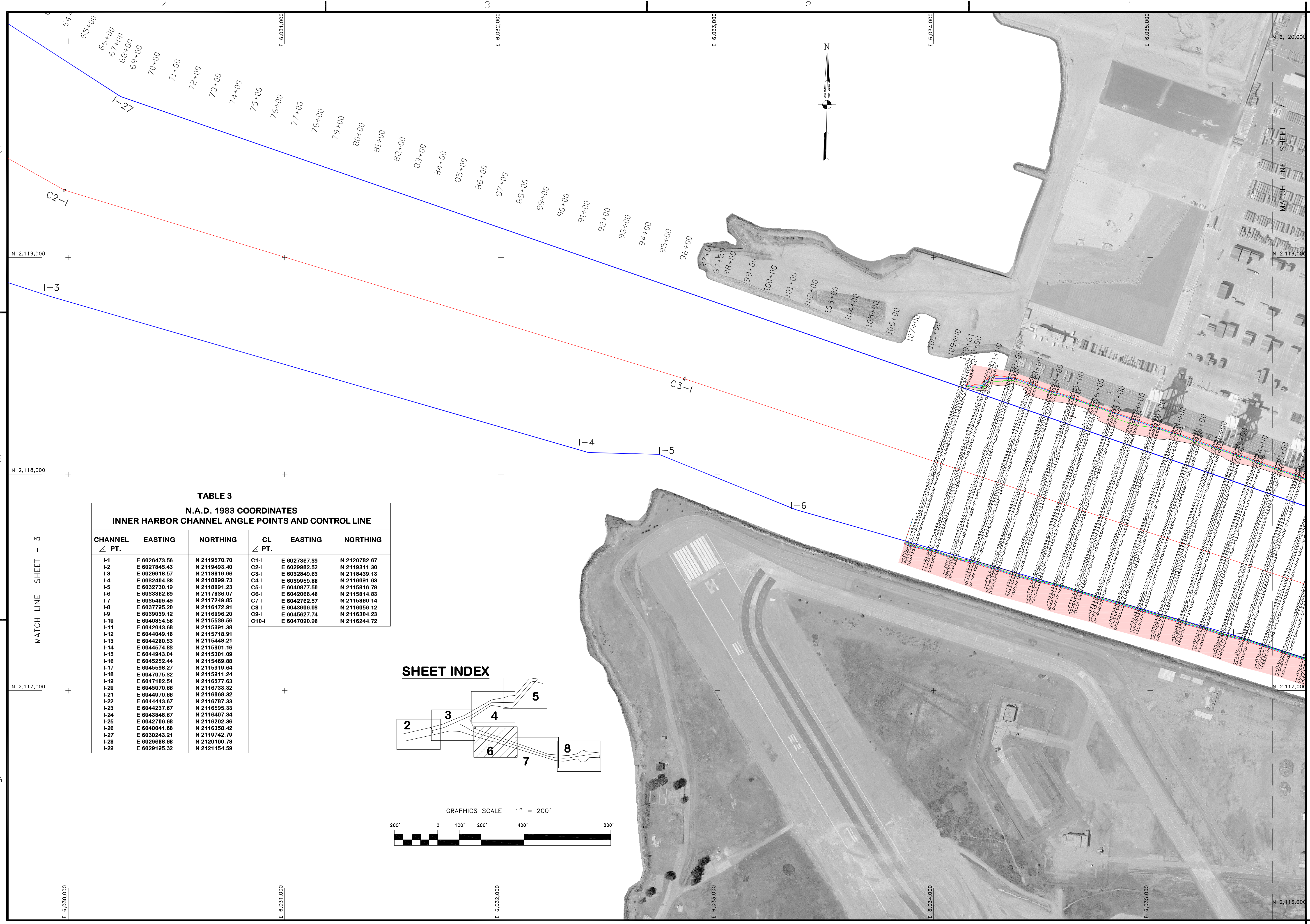

**TABLE 3
N.A.D. 1983 COORDINATES
INNER HARBOR CHANNEL ANGLE POINTS AND CONTROL LINE**

CHANNEL ∠ PT.	EASTING	NORTHING	CL ∠ PT.	EASTING	NORTHING
I-1	E 6026473.56	N 2119570.70	C1-I	E 6027367.39	N 2120782.67
I-2	E 6027845.43	N 2119493.40	C2-I	E 6029982.52	N 2119311.30
I-3	E 6029918.57	N 2118819.96	C3-I	E 6032849.63	N 2118439.13
I-4	E 6032404.38	N 2118099.73	C4-I	E 6039959.88	N 2116091.63
I-5	E 6032730.19	N 2118091.23	C5-I	E 6040877.50	N 2115916.79
I-6	E 6033362.89	N 2117836.07	C6-I	E 6042068.48	N 2115814.83
I-7	E 6035409.49	N 2117249.85	C7-I	E 6042762.57	N 2115860.14
I-8	E 6037795.20	N 2116472.91	C8-I	E 6043906.03	N 2116056.12
I-9	E 6039039.12	N 2116096.20	C9-I	E 6045627.74	N 2116304.23
I-10	E 6040854.58	N 2115539.56	C10-I	E 6047090.98	N 2116244.72
I-11	E 6042043.88	N 2115391.38			
I-12	E 6044049.18	N 2115716.91			
I-13	E 6044280.53	N 2115448.21			
I-14	E 6044574.83	N 2115301.16			
I-15	E 6044943.04	N 2115301.09			
I-16	E 6045252.44	N 2115469.88			
I-17	E 6045598.27	N 2115919.64			
I-18	E 6047075.32	N 2115911.24			
I-19	E 6047102.54	N 2116577.63			
I-20	E 6045070.86	N 2116733.32			
I-21	E 6044970.86	N 2116968.32			
I-22	E 6044443.87	N 2116787.33			
I-23	E 6044237.67	N 2116595.33			
I-24	E 6043848.67	N 2116407.34			
I-25	E 6042706.88	N 2116202.36			
I-26	E 6040041.88	N 2116358.42			
I-27	E 6030243.21	N 2119742.79			
I-28	E 6029688.68	N 2120100.78			
I-29	E 6029195.32	N 2121154.59			

