

**PRELIMINARY ISSUE**  
THIS PLAN ISSUED FOR  
ADVANCE INFORMATION ONLY

**TABLE 1**  
**N.A.D. 1983 COORDINATES**  
**OUTER HARBOR CHANNEL ANGLE POINTS AND CONTROL LINE**

CHANNEL ∠ PT.	EASTING	NORTHING	∠ PT.	EASTING	NORTHING
O-1	E 6029195.32	N 2121154.59	C1-O	E 6027223.76	N 2120719.23
O-2	E 6032145.86	N 2123096.60	C2-O	E 6028185.70	N 2121144.22
O-3	E 6035035.45	N 2122691.23	C3-O	E 6028997.45	N 2121502.85
O-4	E 6036139.65	N 2123963.51	C4-O	E 6029354.81	N 2121699.81
O-5	E 6038502.15	N 2126685.88	C5-O	E 6030364.92	N 2122333.43
O-6	E 6038225.45	N 2126792.32	C6-O	E 6032165.53	N 2123462.86
O-7	E 6037357.62	N 2126663.70	C7-O	E 6032193.00	N 2123463.27
O-8	E 6035497.65	N 2124519.77	C8-O	E 6034212.79	N 2123492.13
O-9	E 6035435.04	N 2124447.60	C9-O	E 6035180.13	N 2123505.95
O-10	E 6034521.88	N 2124383.85	C10-O	E 6035818.57	N 2124241.71
O-11	E 6034015.75	N 2124177.44	C11-O	E 6036937.35	N 2125530.89
O-12	E 6032185.18	N 2123829.00	C12-O	E 6037620.33	N 2126318.15
O-13	E 6028402.05	N 2121692.56	C13-O	E 6038445.33	N 2126785.15
O-14	E 6027018.64	N 2121132.23			

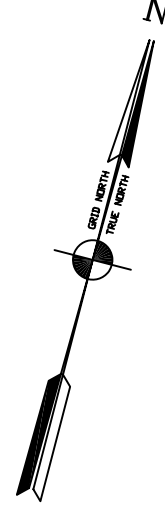

**LEGEND:**

	-50'
	-49'
	-48'
	-47'
	-46'

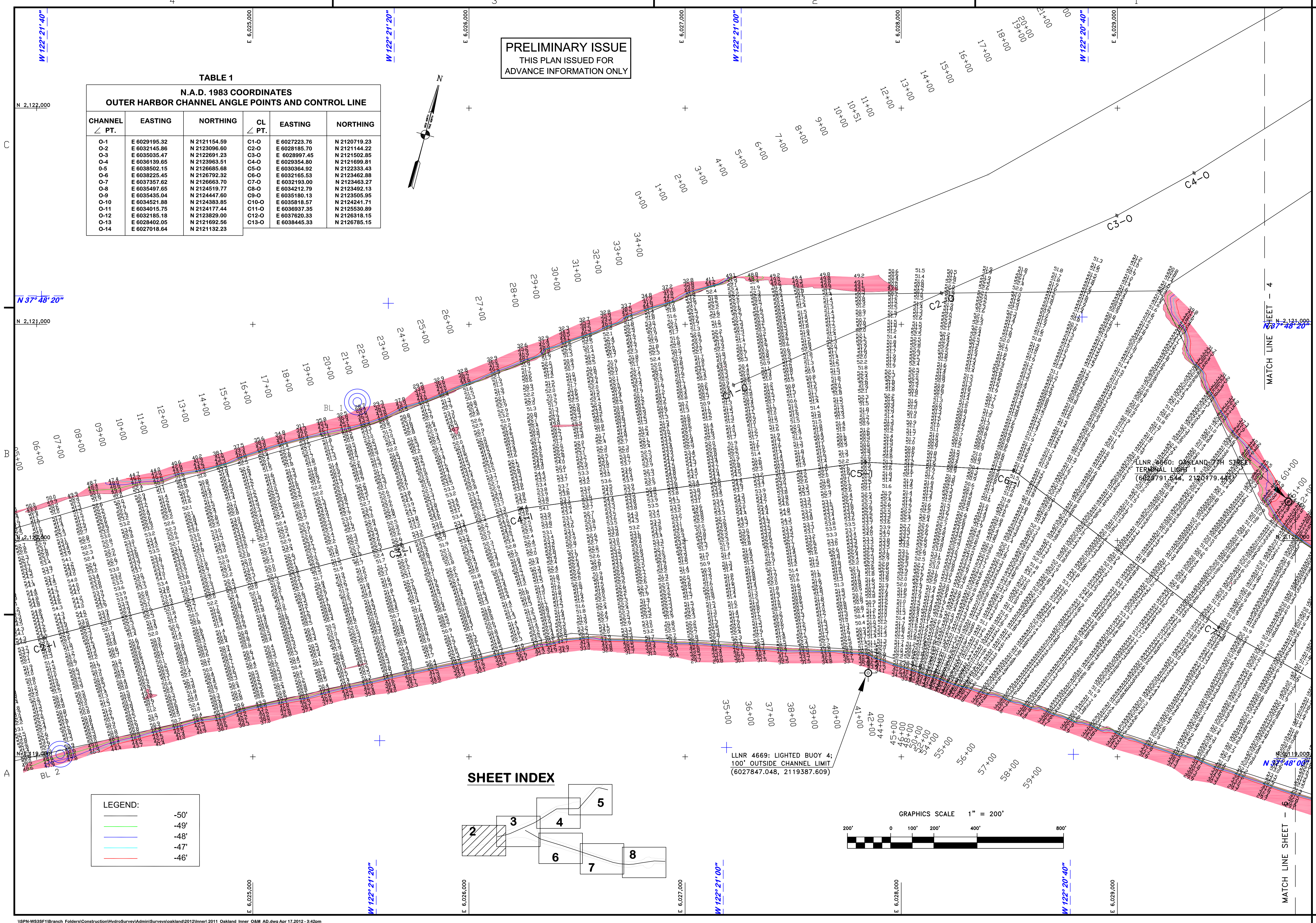
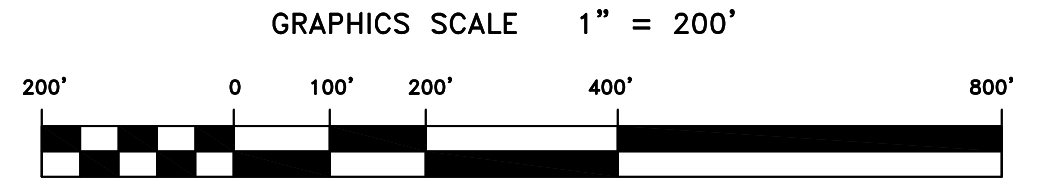
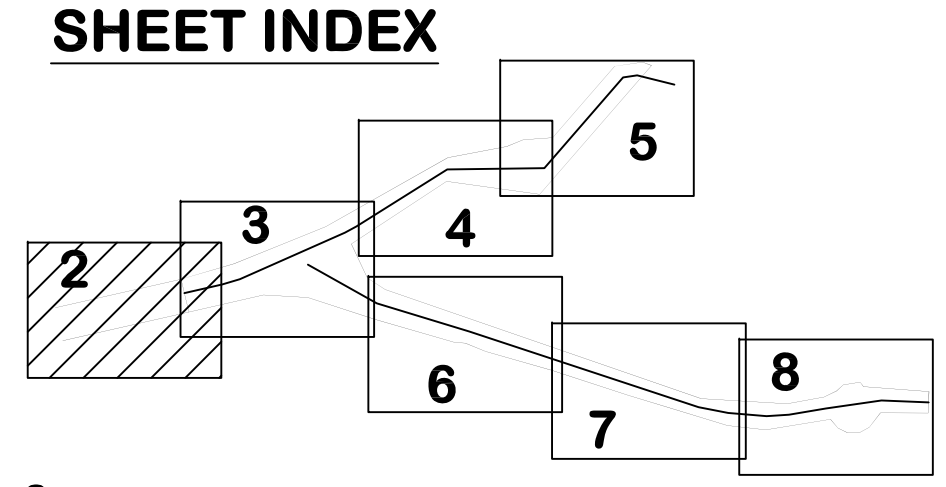

US Army Corps  
of Engineers  
San Francisco District  
1455 Market Street  
San Francisco, CA 94103

Mark	Description	Date	Appr.

DESIGNED BY:	PDT	CHECKED BY:	PDI
DATE:	4/12/2012	DATE:	4/12/2012
APPROVAL RECOMMENDED:	3 OF 8	APPROVAL RECOMMENDED:	2
CHIEF, Geomatics Section	TORREY A. DIGIRO	CHIEF, Geomatics Section	TORREY A. DIGIRO
APPROVED:	PREPARED UNDER THE DIRECTION OF	APPROVED:	PREPARED UNDER THE DIRECTION OF
Chief, Construction Branch	LT. COLONEL C.E. DISTRICT ENGINEER	Chief, Construction Branch	LT. COLONEL C.E. DISTRICT ENGINEER

ALAMEDA COUNTY  
**OAKLAND HARBOR**  
INNER HARBOR  
POSTDREDGE SURVEY  
& 24 JANUARY, 3 FEBRUARY,  
17 MARCH, 9 APRIL 2012

Sheet reference number  
**C3**