

PRELIMINARY ISSUE  
THIS PLAN ISSUED FOR  
ADVANCE INFORMATION ONLY

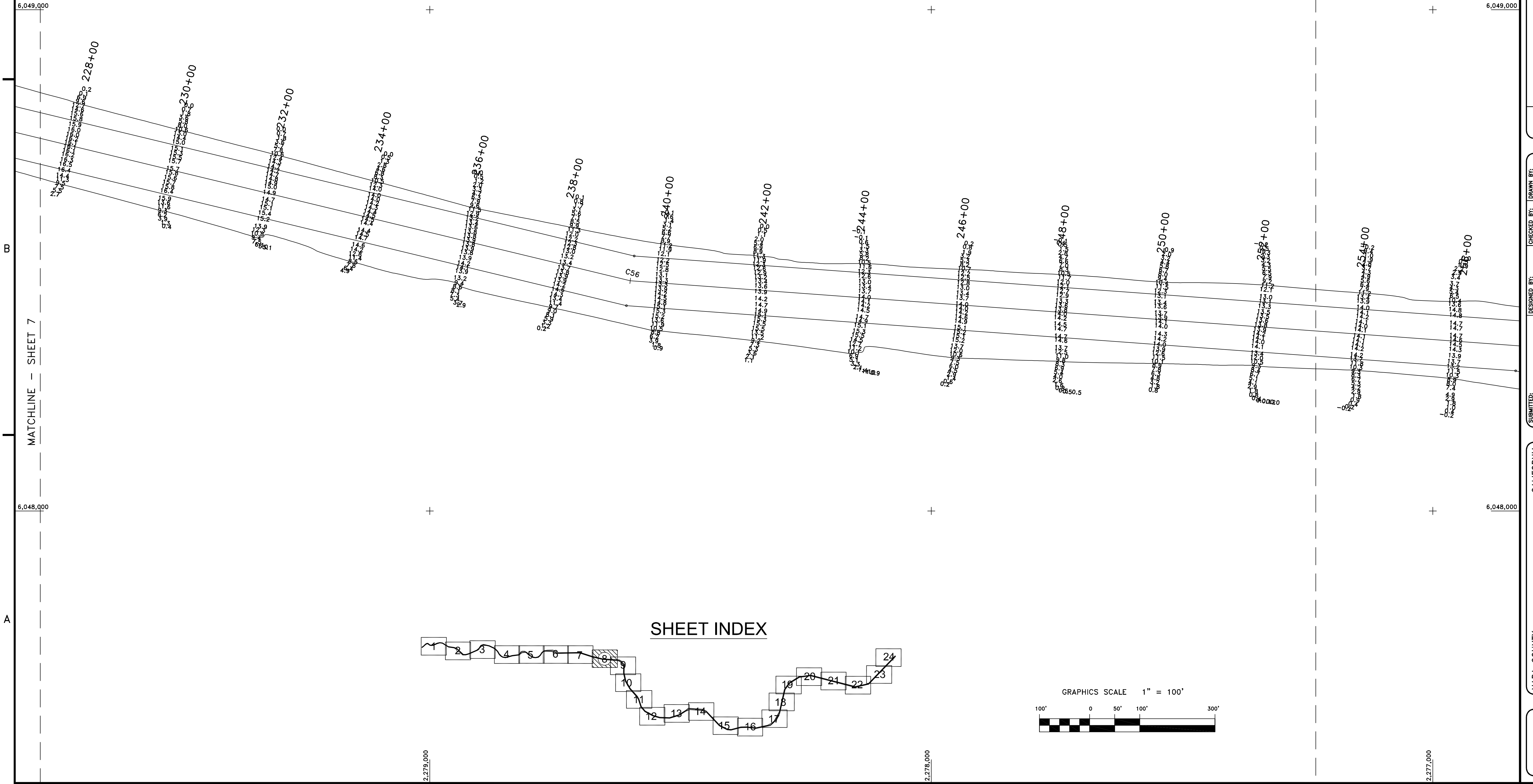
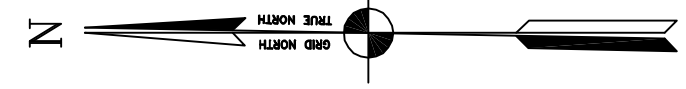

US Army Corps  
of Engineers  
San Francisco District  
1455 Market Street  
San Francisco, CA 94103

Mark	Description	Date	Appr.

SUBMITTED: MC Hydro Survey Team Leader	DESIGNED BY:	CHECKED BY:	DRAWN BY:
	DATE:	DATE:	DATE:
APPROVAL RECOMMENDED:	SHEET NO.:	T.V.W.	EWC
APPROVED:	8 OF 24	8 OF 24	2 OF 2
	DATE:	DATE:	DATE:
	6/13/2008	6/13/2008	6/13/2008
	PREPARED UNDER THE DIRECTION OF		
	CRAIG W. KILEY		
	LT. COLONEL, C.E., DISTRICT ENGINEER		

CALIFORNIA  
NAPA COUNTY  
NAPA RIVER  
CONDITION SURVEY  
06, 9-11 JUNE 2008

Sheet  
reference  
number  
C8