

PRELIMINARY ISSUE
THIS PLAN ISSUED FOR
ADVANCE INFORMATION ONLY

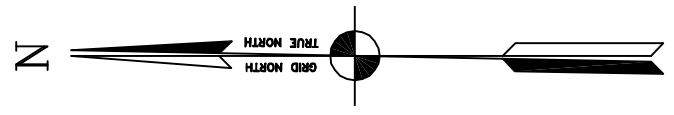

**US Army Corps
of Engineers**
 San Francisco District
 1455 Market Street
 San Francisco, CA 94103

Mark	Description	Date	Appr.

SUBMITTED:	MC	DESIGNED BY:	TVW	CHECKED BY:	EWC
<small>Hydro Survey Team Leader</small>					
APPROVAL RECOMMENDED:		DATE:	SHEET NO.	DRAWING NO.	DRAWING NO.
<small>Chief, Technical Support Section</small>		6/13/2008	7 OF 24	50	2 165
APPROVED:		PREPARED UNDER THE DIRECTION OF			
<small>Chief, Construction Branch</small>		CRAIG W. KILEY			
		LT. COLONEL, C.E., DISTRICT ENGINEER			

CALIFORNIA
NAPA COUNTY
NAPA RIVER
CONDITION SURVEY
 06, 9-11 JUNE 2008

Sheet reference number
C7

SHEET INDEX

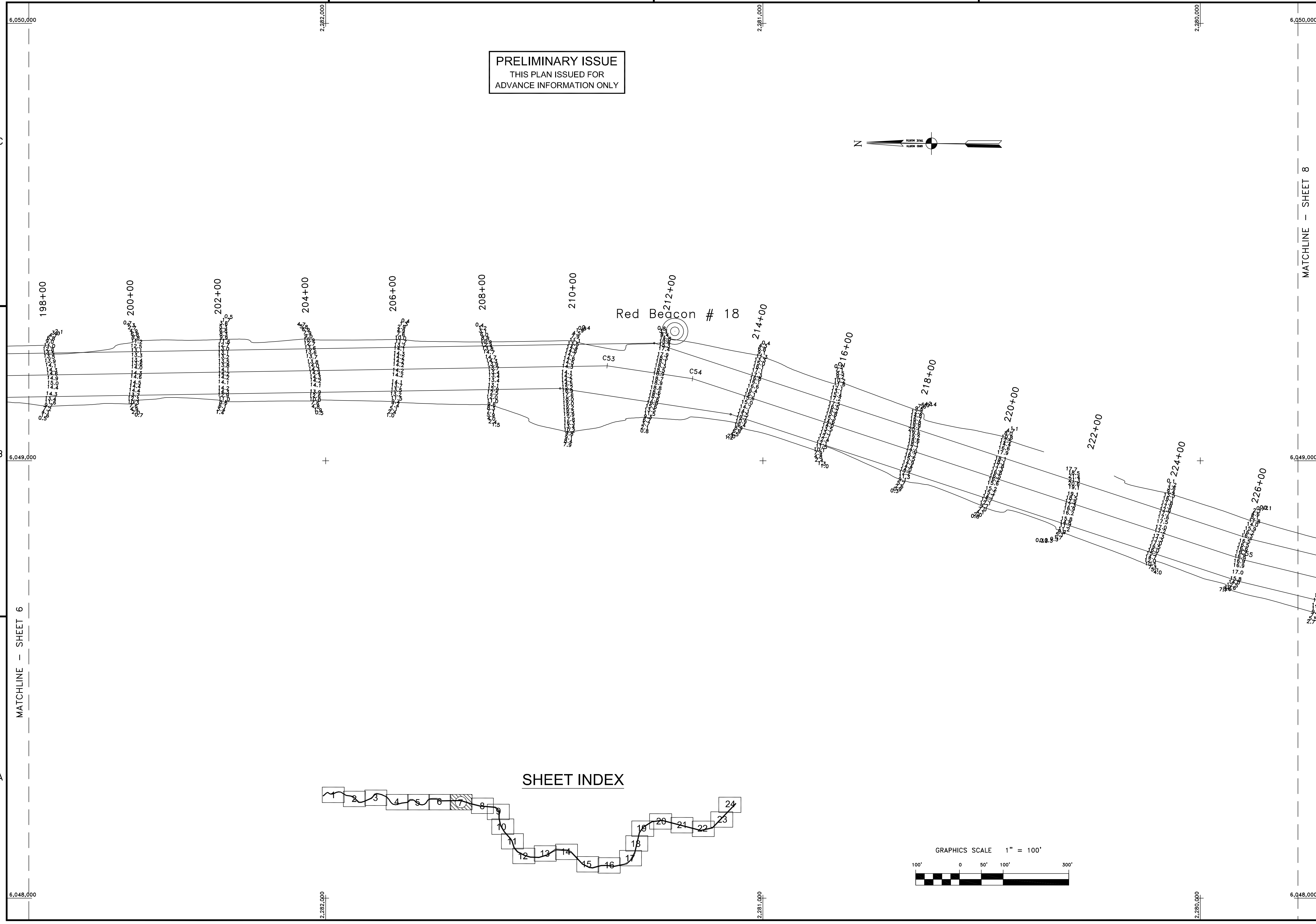
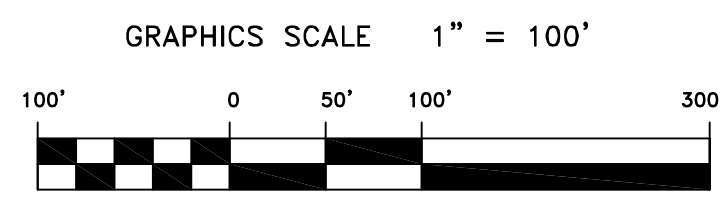
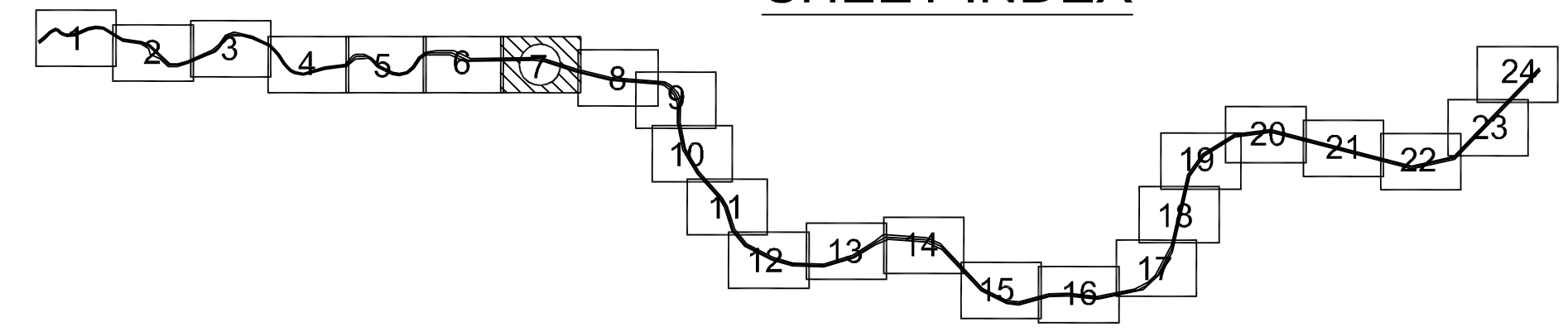

MATCHLINE - SHEET 8

MATCHLINE - SHEET 6

C

B

A

4

3

2

1

6,050,000

2,282,000

2,281,000

2,280,000

6,050,000

6,049,000

6,049,000

6,048,000

2,282,000

2,281,000

2,280,000

6,048,000