

PRELIMINARY ISSUE
THIS PLAN ISSUED FOR
ADVANCE INFORMATION ONLY



US Army Corps
of Engineers
San Francisco District
1455 Market Street
San Francisco, CA 94103

MATCHLINE - SHEET 16

Mark	Description	Date	Appr.

DESIGNED BY:	CHECKED BY:	DRAWN BY:	PDT

DATE: 04/19/2012 1 OF 24 50 2

APPROVAL RECOMMENDED: CHIEF, Geological Section
APPROVED: CHIEF, Construction Branch

PREPARED UNDER THE DIRECTION OF
TORREY A. DICIRO
LT. COLONEL, C.E., DISTRICT ENGINEER

CALIFORNIA
NAPA COUNTY
NAPA RIVER
CONDITION SURVEY
3-7 & 12, 17 & 19 APRIL 2012

Sheet
reference
number
C15

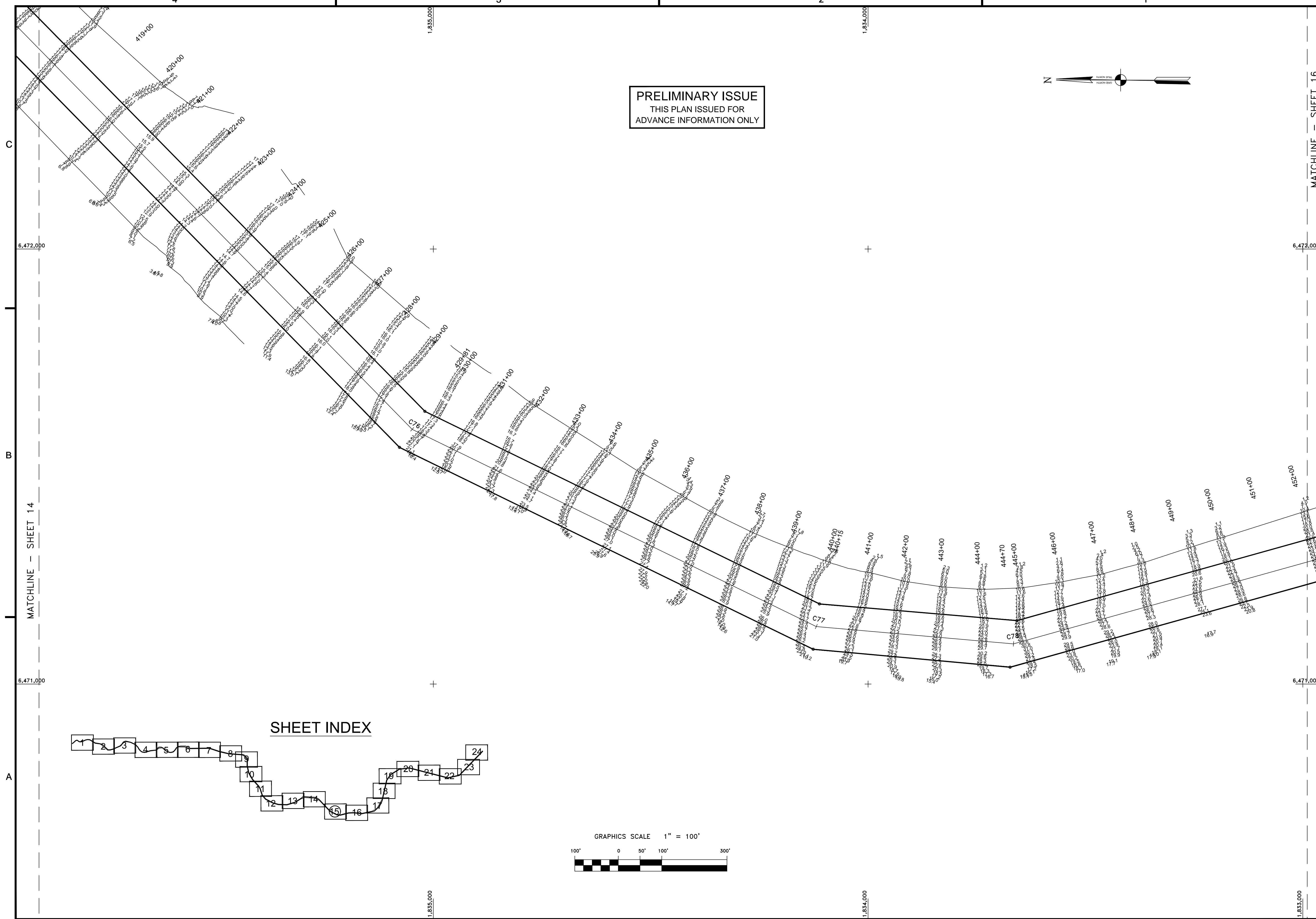

SHEET INDEX

