

6,051,500
W 122° 16' 20"

N 38° 04' 00"

2,215,400

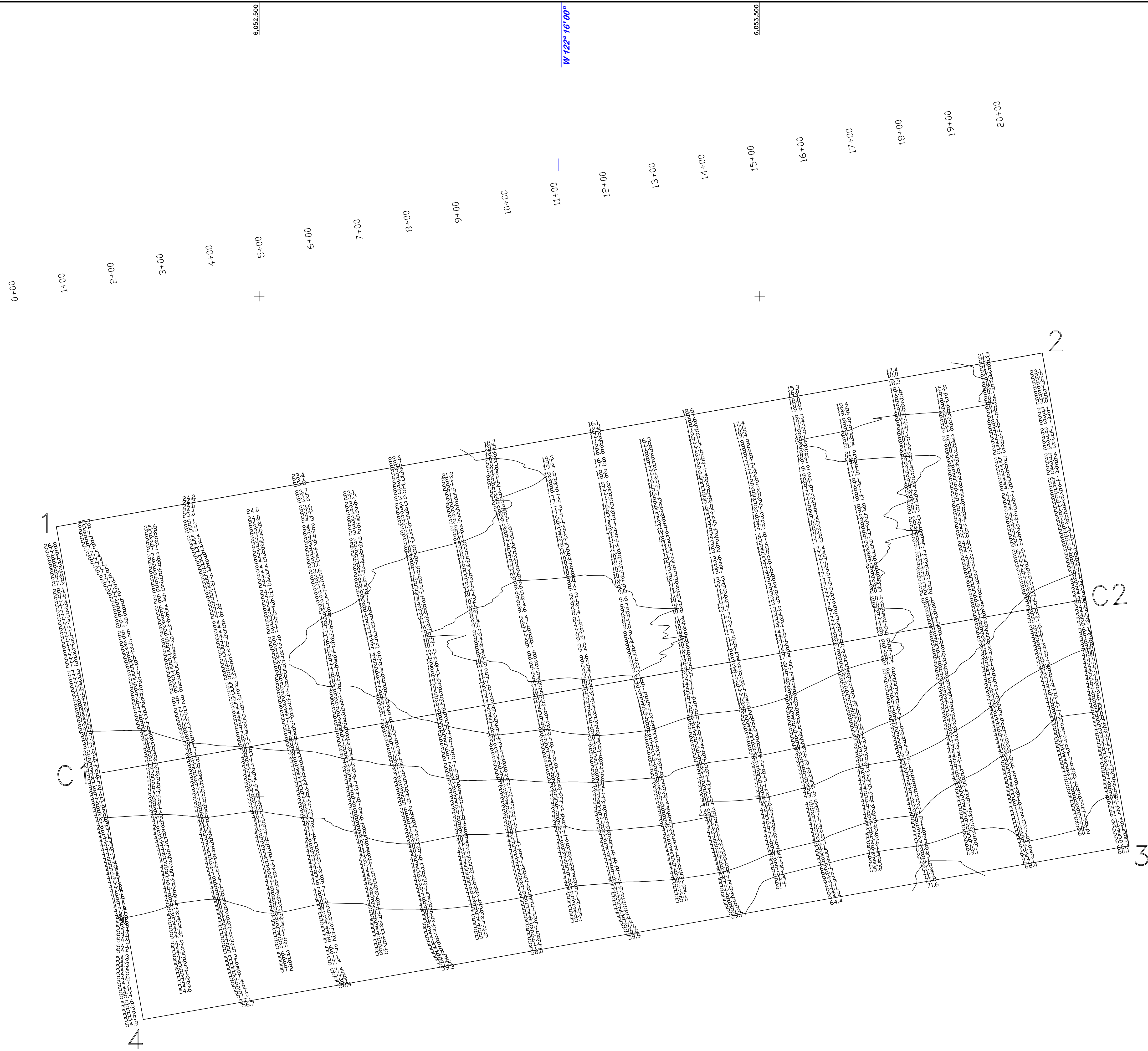
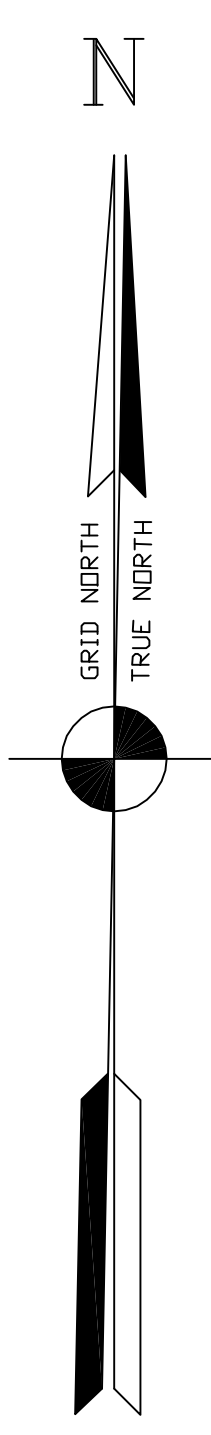

2,214,400

N 38° 03' 40"

2,213,400

W 122° 16' 20"

W 122° 16' 00"

NOTES:

DRAWINGS NOT TO BE USED AS NAVIGATION CHART. ONLY CHANNEL CONDITION AT DATE OF SURVEY. THE LOCATION OF ALL NAVIGATION AIDS ARE BASED ON INFORMATION PROVIDED BY THE U.S. COAST GUARD BUOY LOCATIONS REPRESENT THE POSITION OF THE SINKER ONLY.

SURVEYED BY THE CORPS OF ENGINEERS

SOUNDINGS ARE TAKEN BY FATHOMETER AND ARE SHOWN TO THE NEAREST FOOT AND TENTHS OF A FOOT.

SOUNDINGS ARE BASED ON THE DATUM OF MEAN LOWER LOW WATER AT THE LOCALITY.

PLANE GRID, BEARING AND COORDINATES ARE BASED ON THE STATE OF CALIFORNIA COORDINATE SYSTEM, LAMBERT CONFORMAL PROJECTION, ZONE III NAD 83, CALIFORNIA, AS DESCRIBED IN SPECIAL PUBLICATION NO. 253, PUBLISHED BY NATIONAL OCEAN SURVEY.

THE PROJECT DEPTH IS 50 FEET AT M.L.L.W.

SOUNDINGS ARE BASED ON THE TIDE GAUGE LOCATED AT MARE ISLAND COAST GUARD DOCK VERTICAL CONTROL L486 1950 USC&GS DISK. ELEV. 13.89 FT MLLW TIDAL 5218L USC&GS DISK. ELEV. 11.04 FT MLLW HORIZONTAL CONTROL COAST GUARD D-BEACON

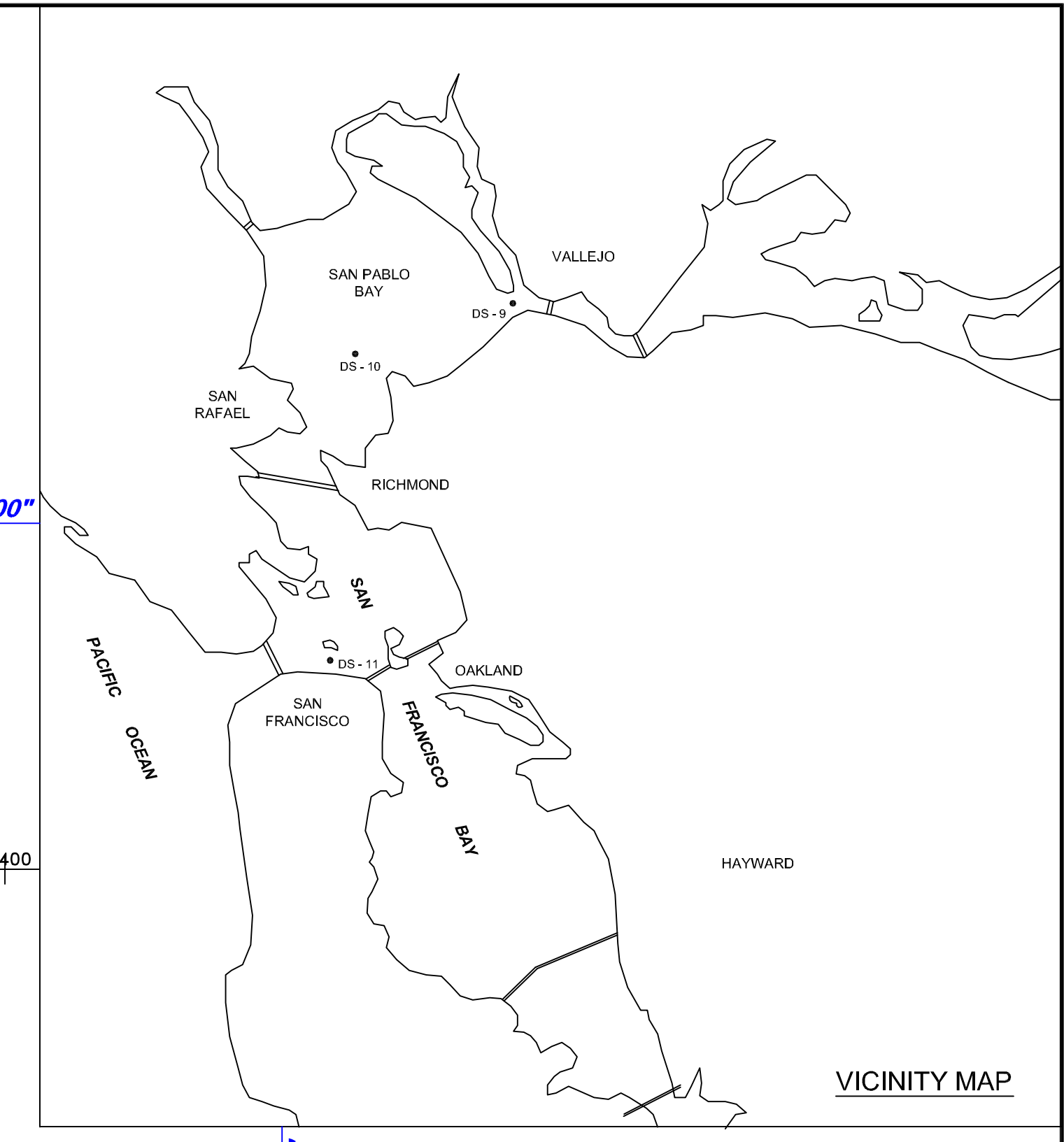

N 38° 04' 00"

2,215,400

COORDINATES CHART

CHANNEL PT.	X	Y
1	6052094.6100	2214939.5300
2	6054064.3100	2215286.8300
3	6054237.9100	2214302.0300
4	6052268.3100	2213954.7300

CENTERLINE PT.	X	Y
C1	6052181.5100	2214447.1300
C2	6054151.1100	2214794.4300

PRELIMINARY ISSUE
THIS PLAN ISSUED FOR
ADVANCE INFORMATION ONLY

N 38° 03' 40"

DRAWN BY: PDT		SOLANO-CONTRA COSTA COUNTY		CALIFORNIA	
CHECKED BY: PDT		US ARMY CORPS OF ENGINEERS SAN FRANCISCO DISTRICT			
DESIGNED BY:					
SUBMITTED: PDT					
HYDRO SURVEY TEAM LEADER:		APPROVED:		DATE:	
CHIEF, GEOMATICS SECTION		CHIEF, CONSTRUCTION BRANCH		SCALE: 1" = 100'	
PREPARED UNDER THE DIRECTION OF TORREY A. DICIRO L.T. COLONEL, C.E., DISTRICT ENGINEER		JOB NO.:		DRAWING NUMBER	
SHEET: 1 OF 1		51		2	