

PRELIMINARY ISSUE
THIS PLAN ISSUED FOR
ADVANCE INFORMATION ONLY

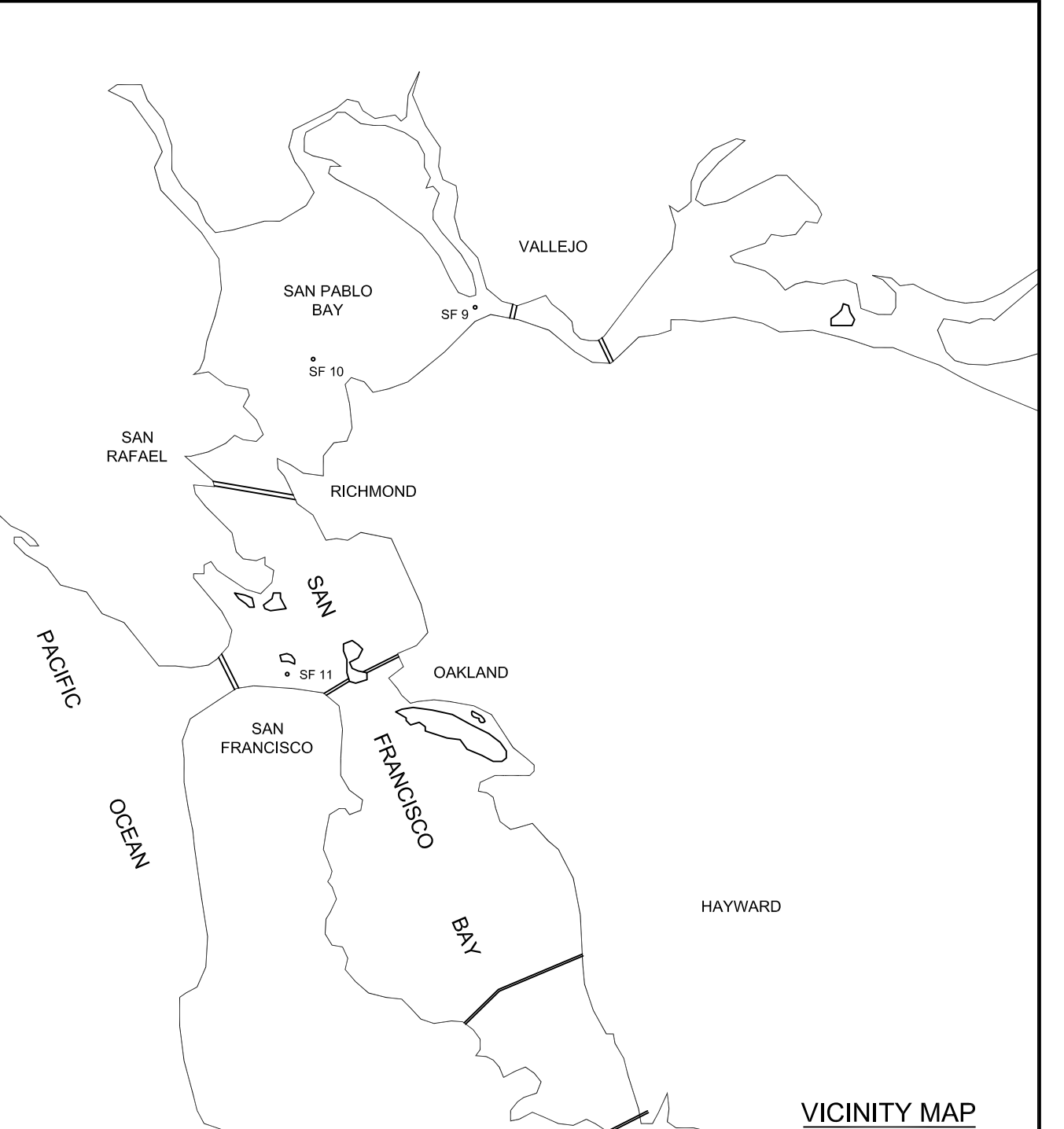
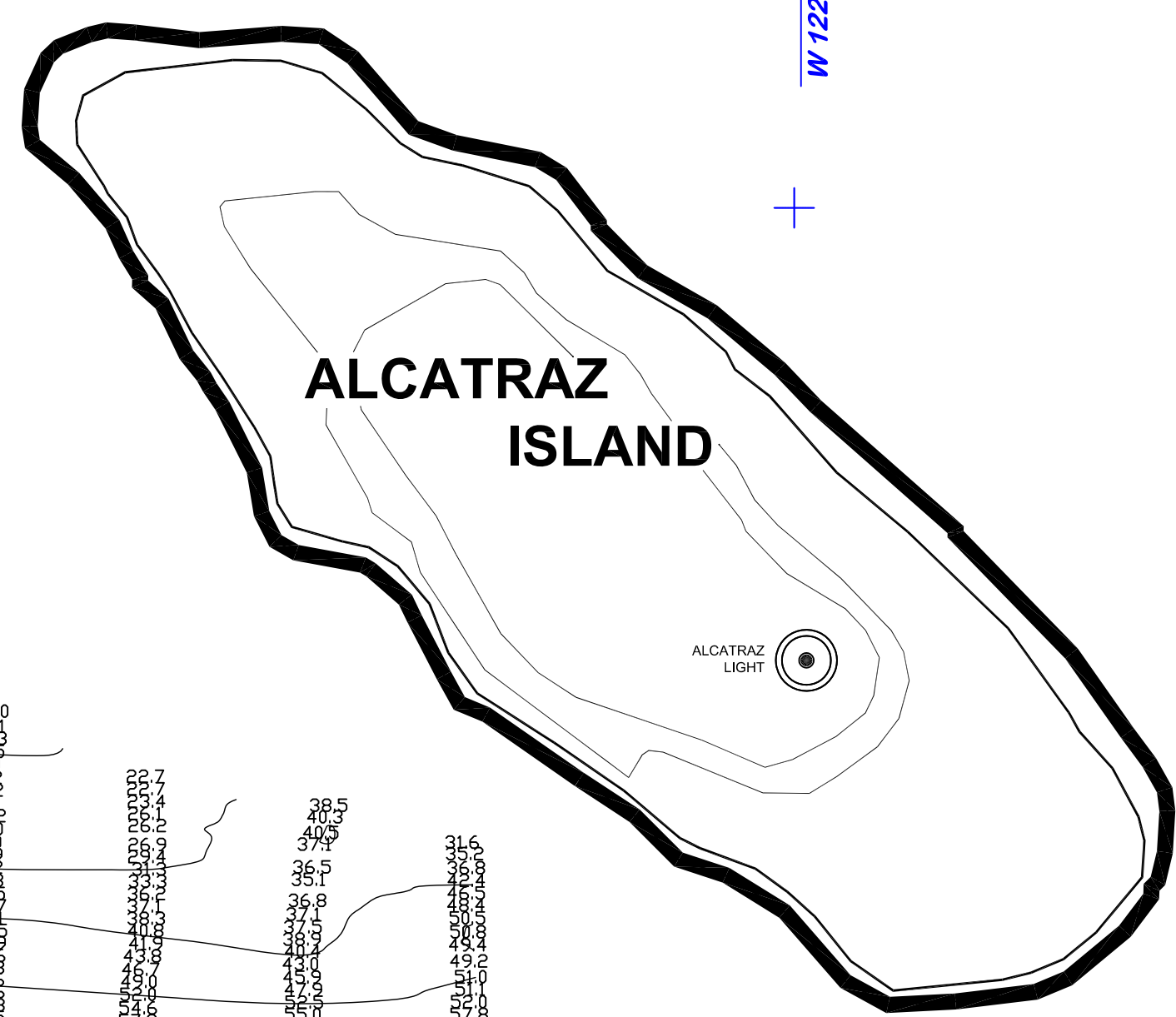

LAMBERT COORDINATES		
POINT	X	Y
U.S.G.S. MON. 57 ELEV. - 14.00	6,005,367	2,123,290
TRANSAMERICA BUILDING	6,011,912	2,117,586
ALCATRAZ DISPOSAL SITE - (SF-11)		
1,000' FT. RADIUS	6,005,935	2,127,235
ALCATRAZ LIGHT	6,006,552	2,129,010
ALCATRAZ BUOY	6,006,367	2,127,186

NOTES:
DRAWING NOT TO BE USED AS NAVIGATION.
ONLY CHANNEL CONDITION AT DATE OF SURVEY.
THE LOCATION OF ALL NAVIGATION AIDS ARE BASED ON
INFORMATION PROVIDED BY THE U.S. COAST GUARD.
BUOY LOCATIONS REPRESENT THE POSITION OF THE SINKER ONLY.
INFORMATION DEPICTED ON THIS MAP REPRESENTS THE RESULTS
OF SURVEYS MADE ON THE DATES INDICATED AND CAN ONLY BE
CONSIDERED AS INDICATING THE GENERAL CONDITIONS EXISTING
AT THAT TIME.
SURVEYED BY THE CORPS OF ENGINEERS.
SOUNDINGS ARE TAKEN BY FATHOMETER AND ARE SHOWN TO THE
NEAREST FOOT AND TENTHS OF A FOOT.
SOUNDINGS ARE BASED ON THE DATUM OF MEAN LOWER LOW WATER
AT THE LOCALITY.
PLANE GRID, BEARING AND COORDINATES ARE BASED ON THE STATE
OF CALIFORNIA COORDINATE SYSTEM, LAMBERT CONFORMAL PROJECTION,
ZONE 18 NAD 83, CALIFORNIA, AS DESCRIBED IN SPECIAL PUBLICATION
NO. 253, PUBLISHED BY NATIONAL OCEAN SURVEY.
THE PROJECT DEPTH IS 40 FEET AT M.L.L.W.
SOUNDINGS ARE BASED ON THE TIDE GAUGE LOCATED AT THE HYDE
STREET PIER, SAN FRANCISCO, CALIFORNIA.
VERTICAL CONTROL
BENCHMARK "56" ELEV. 12.71 FT MLLW
HORIZONTAL CONTROL
COAST GUARD D-BEACON

SYMBOL	DESCRIPTION	DATE	APPROVAL
REVISIONS			
DRAWN BY: PDT		SAN FRANCISCO CO.	
CHECKED BY: PDT		ALCATRAZ DISPOSAL SITE - SF11	
DESIGNED BY:		CONDITION SURVEY	
SUBMITTED: PDT		01 JUNE 2013	
HYDRO SURVEY TEAM LEADER		APPROVED: _____ DATE: _____	
APPROVAL RECOMMENDED:		CHIEF, CONSTRUCTION BRANCH	
PREPARED UNDER THE DIRECTION OF		SCALE: 1"=200' [JOB NO.:	
JOHN K. BAKER		DRAWING NUMBER	
LT. COLONEL, C.E., DISTRICT ENGINEER		SHEET: 1 OF 1 1 2 XXX	

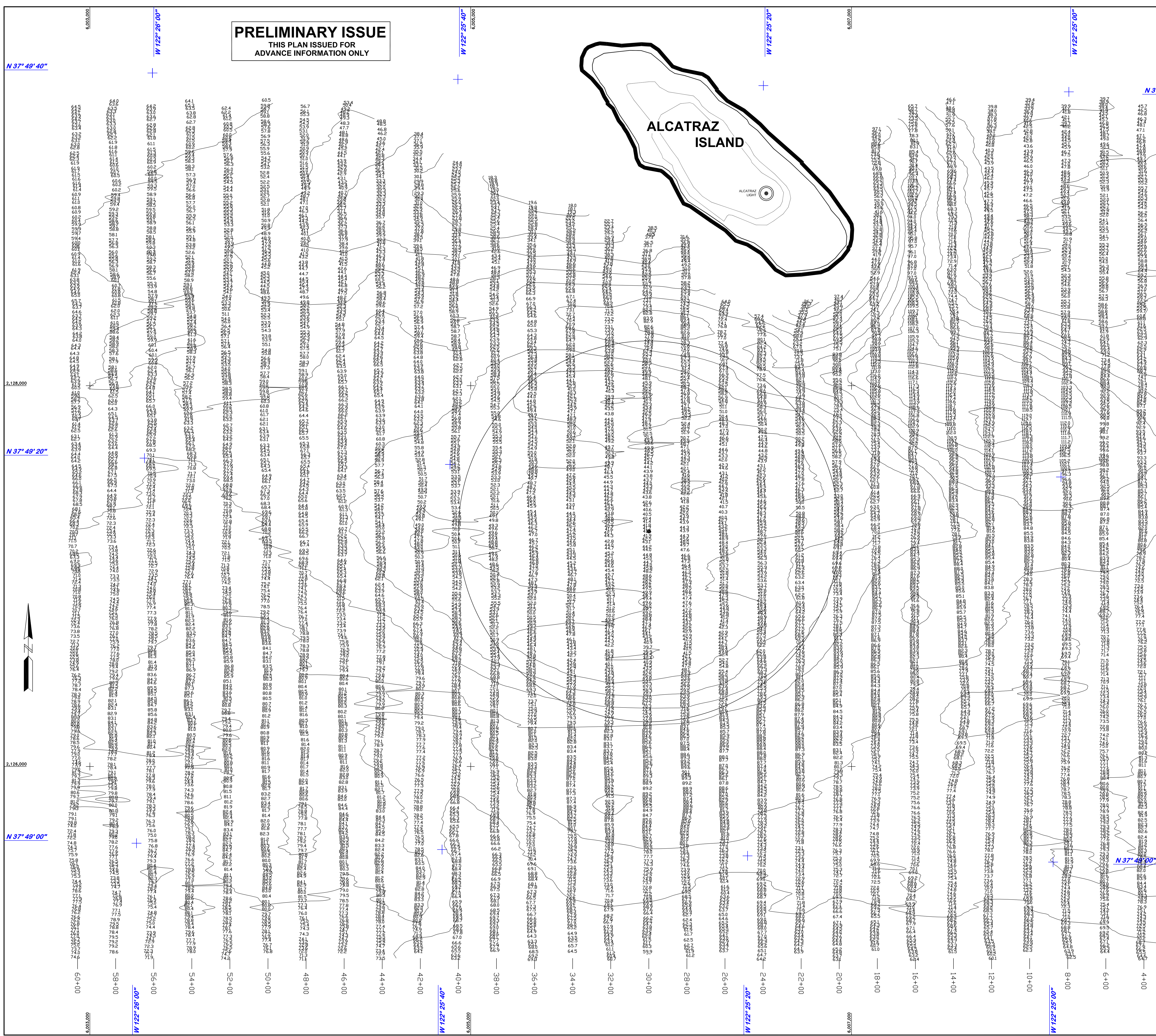

N 37° 49' 40"

W 122° 26' 00"

W 122° 25' 40"

W 122° 25' 20"

W 122° 25' 00"

N 37° 49' 40"

W 122° 24' 40"

N 37° 49' 20"

N 37° 49' 20"

W 122° 24' 20"

N 37° 49' 00"

N 37° 49' 00"

W 122° 26' 22.11"

W 122° 26' 22.11"

W 122° 26' 22.11"

2,128,000

2,128,000

2,128,000

2,128,000

6,003,000

6,003,000

6,003,000

6,003,000

6,003,000

6,003,000

605
606
607
608
609
610
611
612
613
614
615
616
617
618
619
620
621
622
623
624
625
626
627
628
629
630
631
632
633
634
635
636
637
638
639
640
641
642
643
644
645
646
647
648
649
650
651
652
653
654
655
656
657
658
659
660
661
662
663
664
665
666
667
668
669
670
671
672
673
674
675
676
677
678
679
680
681
682
683
684
685
686
687
688
689
690
691
692
693
694
695
696
697
698
699
700
701
702
703
704
705
706
707
708
709
710
711
712
713
714
715
716
717
718
719
720
721
722
723
724
725
726
727
728
729
730
731
732
733
734
735
736
737
738
739
740
741
742
743
744
745
746
747
748
749
750
751
752
753
754
755
756
757
758
759
760
761
762
763
764
765
766
767
768
769
770
771
772
773
774
775
776
777
778
779
780
781
782
783
784
785
786
787
788
789
790
791
792
793
794
795
796
797
798
799
800
801
802
803
804
805
806
807
808
809
810
811
812
813
814
815
816
817
818
819
820
821
822
823
824
825
826
827
828
829
830
831
832
833
834
835
836
837
838
839
840
841
842
843
844
845
846
847
848
849
850
851
852
853
854
855
856
857
858
859
860
861
862
863
864
865
866
867
868
869
870
871
872
873
874
875
876
877
878
879
880
881
882
883
884
885
886
887
888
889
890
891
892
893
894
895
896
897
898
899
900
901
902
903
904
905
906
907
908
909
910
911
912
913
914
915
916
917
918
919
920
921
922
923
924
925
926
927
928
929
930
931
932
933
934
935
936
937
938
939
940
941
942
943
944
945
946
947
948
949
950
951
952
953
954
955
956
957
958
959
960
961
962
963
964
965
966
967
968
969
970
971
972
973
974
975
976
977
978
979
980
981
982
983
984
985
986
987
988
989
990
991
992
993
994
995
996
997
998
999
1000