

PRELIMINARY ISSUE
THIS PLAN ISSUED FOR
ADVANCE INFORMATION ONLY

NAD 83 CHANNEL ANGLE POINTS		
LINE NO.	X	Y
1	6070497.14	2029381.41
2	6070532.34	2028732.31
3	6070951.24	2020996.01
4	6070270.24	2019491.41
5	6067215.84	2018664.31
6	6066677.34	2015527.11
7	6066847.04	2015077.21
8	6066598.34	2014551.71
9	6065434.54	2013609.41
10	6065101.54	2012395.71
11	6065191.74	2011949.81
12	6064761.54	2010988.31
13	6064484.54	2010776.31
14	6064278.74	2010735.31
15	6064211.54	2011072.31
16	6063974.74	2011444.51
17	6064312.34	2012208.81
18	6064715.84	2012501.51
19	6065082.74	2013639.31
20	6065866.34	2015167.71
21	6066300.74	2015432.81
22	6066969.44	2016845.51
23	6068927.44	2019562.91
24	6070573.54	2021010.41
25	6070626.34	2021447.71
26	6070386.54	2022444.71
27	6069732.74	2022609.11
28	6069564.44	2022926.91

NAD 83 CENTERLINE ANGLE POINTS		
LINE NO.	X	Y
C1	6070030.84	2029309.11
C2	6070516.34	2026262.81
C3	6070776.14	2021455.81
C4	6070762.44	2021033.21
C5	6070398.84	2019537.11
C6	6067092.84	2016755.11
C7	6066541.74	2015591.31
C8	6066573.94	2015255.01
C9	6065258.64	2013724.31
C10	6064908.74	2012448.81
C11	6064278.74	2010735.31

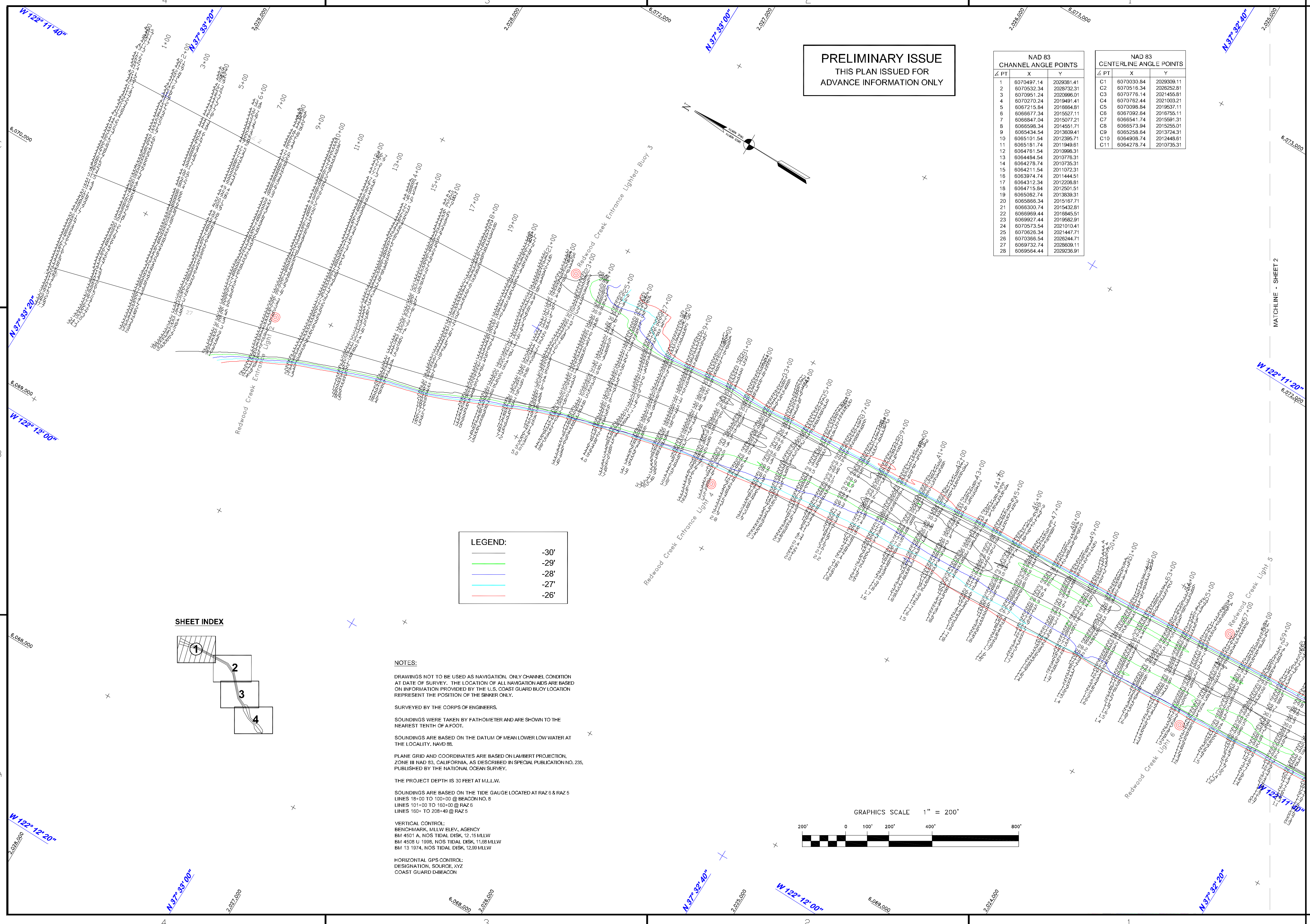

LEGEND:

—	-30'
—	-29'
—	-28'
—	-27'
—	-26'

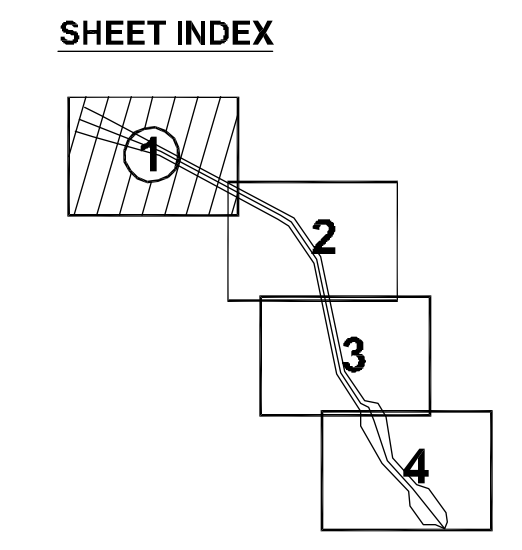

NOTES:

DRAWINGS NOT TO BE USED AS NAVIGATION. ONLY CHANNEL CONDITION AT DATE OF SURVEY. THE LOCATION OF ALL NAVIGATION AIDS ARE BASED ON INFORMATION PROVIDED BY THE U.S. COAST GUARD BUOY LOCATION REPRESENT THE POSITION OF THE SINKER ONLY.

SURVEYED BY THE CORPS OF ENGINEERS.

SOUNDINGS WERE TAKEN BY FATHOMETER AND ARE SHOWN TO THE NEAREST TENTH OF A FOOT.

SOUNDINGS ARE BASED ON THE DATUM OF MEAN LOWER LOW WATER AT THE LOCALITY. NAVD 88.

PLANE GRID AND COORDINATES ARE BASED ON LAMBERT PROJECTION, ZONE III NAD 83, CALIFORNIA, AS DESCRIBED IN SPECIAL PUBLICATION NO. 235, PUBLISHED BY THE NATIONAL OCEAN SURVEY.

THE PROJECT DEPTH IS 30 FEET AT M.L.L.W.

SOUNDINGS ARE BASED ON THE TIDE GAUGE LOCATED AT RAZ 6 & RAZ 5
LINES 18+00 TO 100+00 @ BEACON NO. 8
LINES 101+00 TO 150+00 @ RAZ 6
LINES 160+ TO 208+49 @ RAZ 5

VERTICAL CONTROL:
BENCHMARK, MLLW ELEV, AGENCY
BM 4501 A, NOS TIDAL DISK, 12.15 MLLW
BM 4508 U 1998, NOS TIDAL DISK, 11.88 MLLW
BM 13 1974, NOS TIDAL DISK, 12.99 MLLW

HORIZONTAL GPS CONTROL:
DESIGNATION, SOURCE, XYZ
COAST GUARD D-BEACON

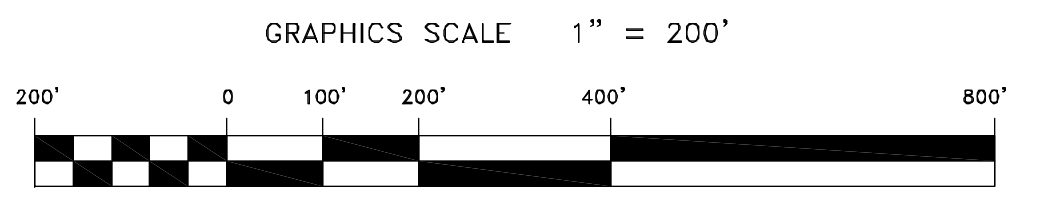

Mark	Description	Date	Appr.

SUBMITTED: PDI Hydro Survey Team Leader	DESIGNED BY: PDI	CHECKED BY: PDI	DRAWN BY: PDI
			PDT
APPROVAL RECOMMENDED:	DATE: 6/02/2011	SHEET NO. 1 OF 4	DRAWING NO. 54
			2
APPROVED:	CHIEF, Technical Support Section	PREPARED UNDER THE DIRECTION OF	XXX
			TORREY A. DICIRO
Chief, Construction Branch		LT. COLONEL, C.E., DISTRICT ENGINEER	

SAN MATEO COUNTY CALIFORNIA
REDWOOD CITY
CONDITION SURVEY
26-27, 31 MAY 2011

Sheet reference number
C1