



DISCLAIMER
The United States Government furnishes this information as a public service. It is not intended to be used for navigation. The user is responsible for the results of any application of this data for other than its intended purpose. The United States Government makes no warranty, expressed or implied, concerning the accuracy, completeness, reliability, usability, or timeliness of the information. The user is responsible for the results of any application of this data for other than its intended purpose. These data belong to the Government. Therefore, the recipient may not transfer these data to others without also transferring the Disclaimer.

Prepared Under the Direction of TRAVIS J. RAYFIELD LT COLONEL, C.E., DISTRICT ENGINEER	Surveyed By: PDT	Chart Date: Oct 17, 2017
Submitted: Hydro Survey Team Leader	Plotted By: PDT	Designed by: PDT
Recommended: Chief, Hydro Survey Section	Checked By: PDT	Drawn by: PDT
Approved: Chief, Construction Branch		

SAN MATEO COUNTY
REWOOD CITY
REACH 1 & 2A
POST-DREDGE SURVEY
29 SEPTEMBER 2017

Sheet Reference Number
1 of 4

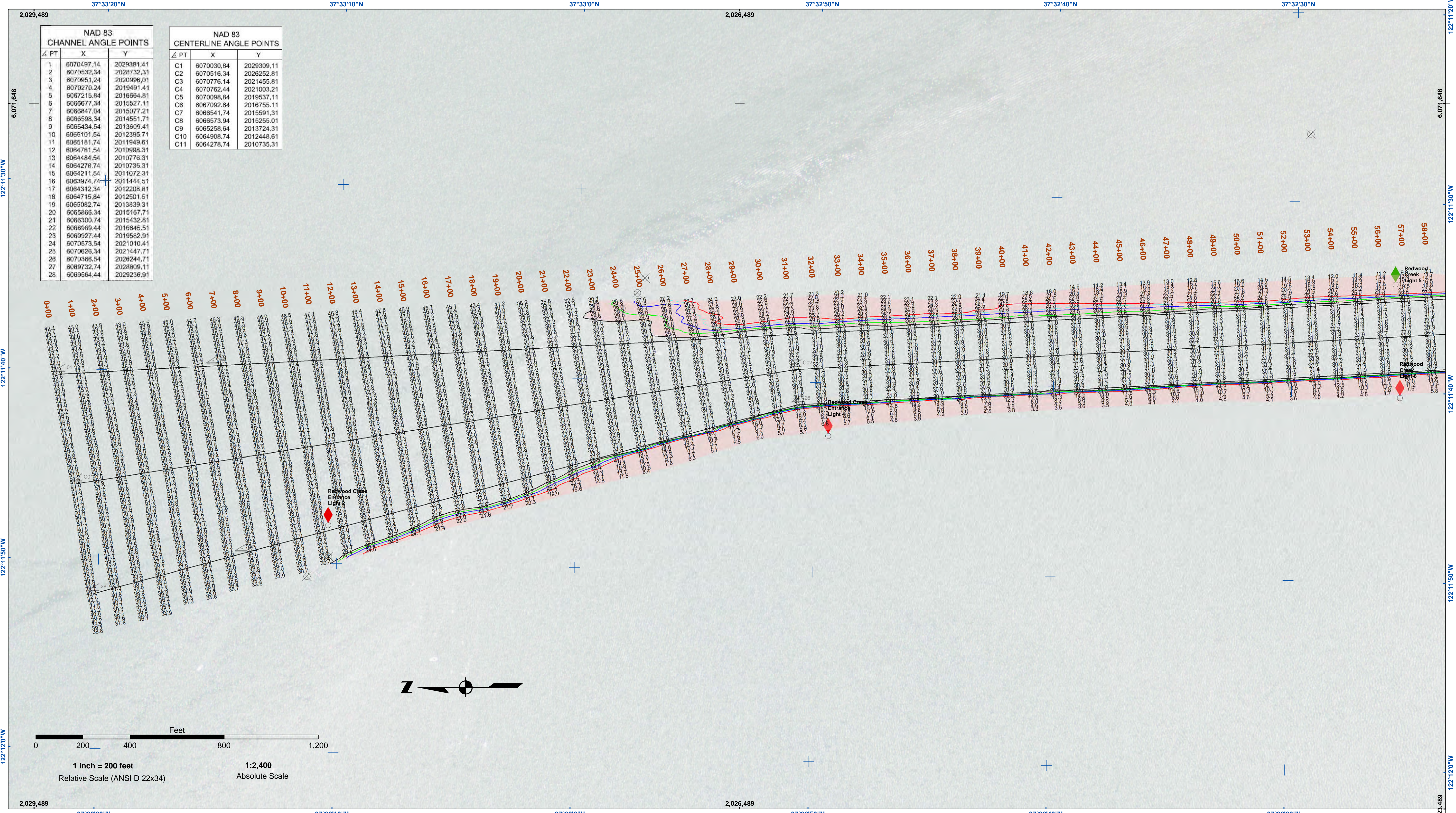

NAD 83 CHANNEL ANGLE POINTS		
PT	X	Y
1	6070497.14	2029381.41
2	6070532.34	2028732.31
3	6070951.24	2020996.01
4	6070270.24	2019491.41
5	6067215.84	2018684.81
6	6068677.34	2015527.11
7	6068847.04	2015077.21
8	6068598.34	2014551.71
9	6065434.54	2013609.41
10	6065101.54	2012395.71
11	6065181.74	2011949.61
12	6064761.54	2010998.31
13	6064484.54	2010776.31
14	6064278.74	2010735.31
15	6064211.54	2011072.31
16	6063974.74	2011444.51
17	6064312.34	2012208.81
18	6064715.84	2012501.51
19	6065082.74	2013839.31
20	6065866.34	2015167.71
21	6066300.74	2015432.81
22	6066969.44	2016845.51
23	6069927.44	2019582.91
24	6070573.54	2021010.41
25	6070628.34	2021447.71
26	6070366.54	2028244.71
27	6069732.74	2028609.11
28	6069564.44	2029236.91

NAD 83 CENTERLINE ANGLE POINTS		
PT	X	Y
C1	6070030.84	2029309.11
C2	6070516.34	2028252.81
C3	6070776.14	2021455.81
C4	6070762.44	2021003.21
C5	6070098.84	2019537.11
C6	6067092.64	2016755.11
C7	6066541.74	2015591.31
C8	6068573.94	2015255.01
C9	6065258.64	2013724.31
C10	6064908.74	2012448.61
C11	6064278.74	2010735.31

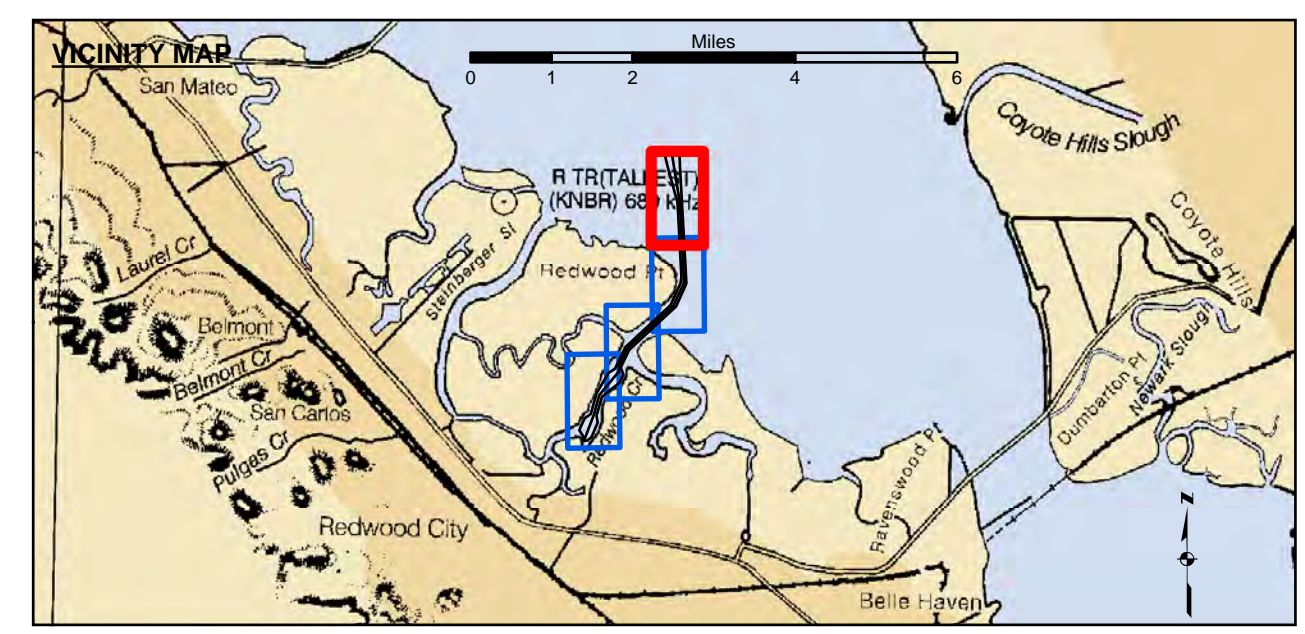

Federal Navigation Channel	Beacon, General	Contours
Shoaling Area	Obstruction Point	-30
Material Placement Area	Navigation Buoy	-29
Anchorage Area	Navigation Buoy	-28
Wreck Area	Shoalest Sounding*	-27
Submerged Wreck		-26
Angle Point		

NOTES:
DRAWING NOT TO BE USED FOR NAVIGATION. ONLY CHANNEL CONDITION AT DATE OF SURVEY.
THE LOCATION OF ALL NAVIGATION AIDS ARE BASED ON INFORMATION PROVIDED BY THE U.S. COAST GUARD. BUOY LOCATIONS REPRESENT THE POSITION OF THE SINKER ONLY.
INFORMATION DEPICTED ON THIS MAP REPRESENTS THE RESULTS OF SURVEYS MADE ON THE DATES INDICATED AND CAN ONLY BE CONSIDERED AS INDICATING THE GENERAL CONDITIONS AT THAT TIME.
SURVEYED BY THE CORPS OF ENGINEERS.
*SHOALEST SOUNDING PER QUARTER PER REACH

SOUNDINGS WERE TAKEN BY FATHOMETER AND ARE SHOWN TO THE NEAREST TENTH OF A FOOT. SOUNDINGS ARE BASED ON THE DATUM OF MEAN LOWER LOW WATER AT THE LOCALITY, NAVD 88. BASE MAPS ARE USDA NAIP 2010.
PLANE GRID, BEARING AND COORDINATES ARE BASED ON THE STATE OF CALIFORNIA COORDINATE SYSTEM, LAMBERT CONFORMAL PROJECTION, ZONE III NAD 83, CALIFORNIA, AS DESCRIBED IN SPECIAL PUBLICATION NO. 235, PUBLISHED BY NATIONAL OCEAN SURVEY.
THE PROJECT DEPTH IS 30 FEET AT M.L.L.W.
SOUNDINGS ARE BASED ON THE TIDE GAUGE LOCATED AT RAZ 6 & RAZ 5
LINES 18+00 TO 100+00 @ BEACON NO. 8
LINES 101+00 TO 160+00 @ RAZ 6
LINES 160+ TO 208+49 @ RAZ 5
VERTICAL CONTROL:
BENCHMARK, MLLW ELEV., AGENCY
BM 4501 A, NOS TIDAL DISK, 12.15 MLLW
BM 4508 U 1998, NOS TIDAL DISK, 11.88 MLLW
BM 13 1974, NOS TIDAL DISK, 12.99 MLLW
HORIZONTAL CONTROL:
DESIGNATION, SOURCE, XYZ
COAST GUARD D-BEACON.

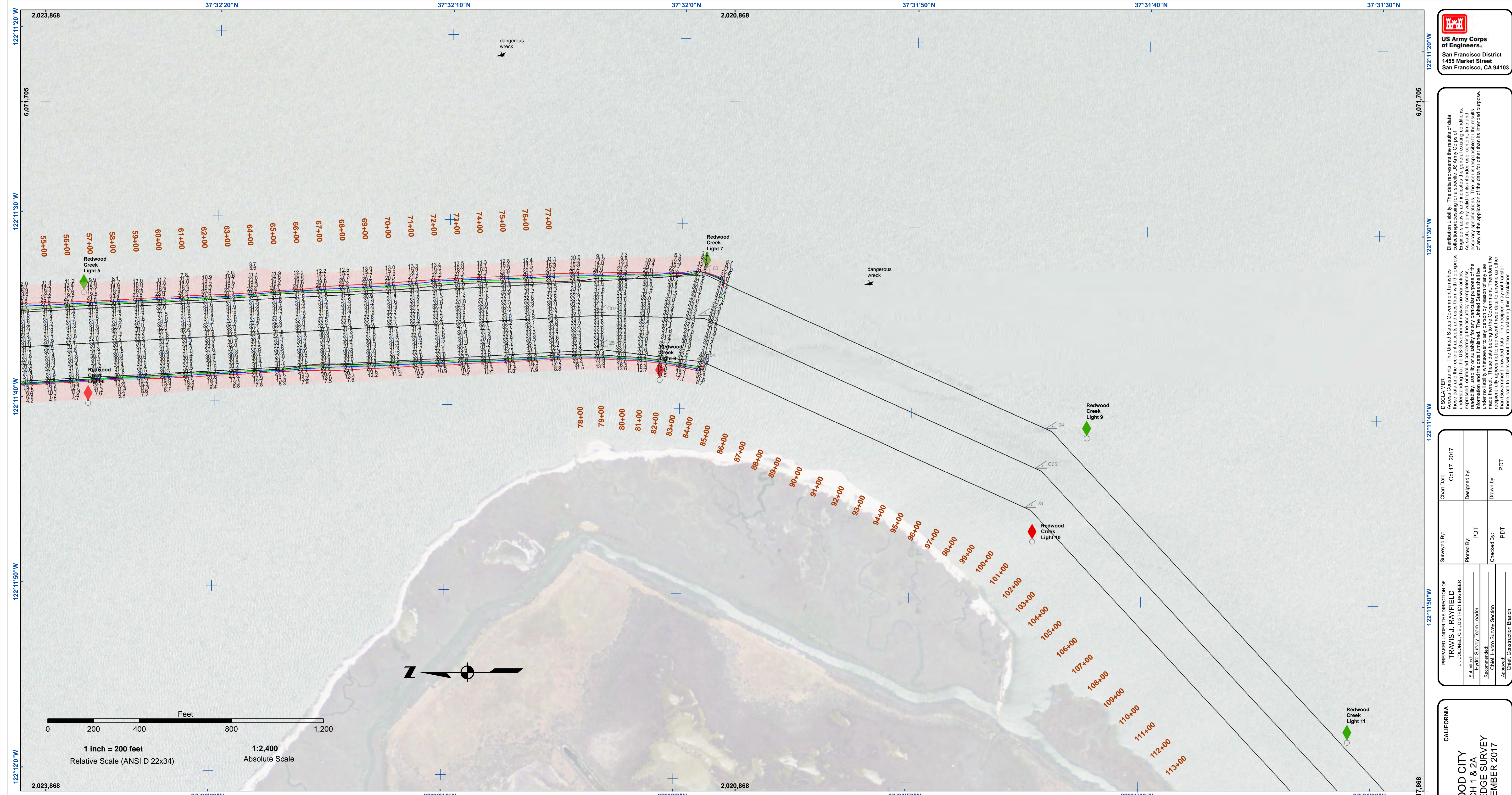

US Army Corps of Engineers
 San Francisco District
 1455 Market Street
 San Francisco, CA 94103

DISCLAIMER
 The United States Government furnishes this information for the general information of the recipient. The data represents the results of data collected by the United States Government and is not intended for navigation. The user is responsible for the results of any use of this information. The user is responsible for the results of any use of this information. The user is responsible for the results of any use of this information.

Prepared Under the Direction of	Chart Date:	Oct 17, 2017
LT. COLONEL, C.E. DISTRICT ENGINEER	Surveyed By:	
Subject: Hydro Survey Team Leader	Plotted By:	PDT
Recommended: Chief, Hydro Survey Section	Checked By:	PDT
Approved: Chief, Construction Branch	Drawn by:	PDT

CALIFORNIA
 SAN MATEO COUNTY
REWOOD CITY
 REACH 1 & 2A
 POST-DREDGE SURVEY
 29 SEPTEMBER 2017

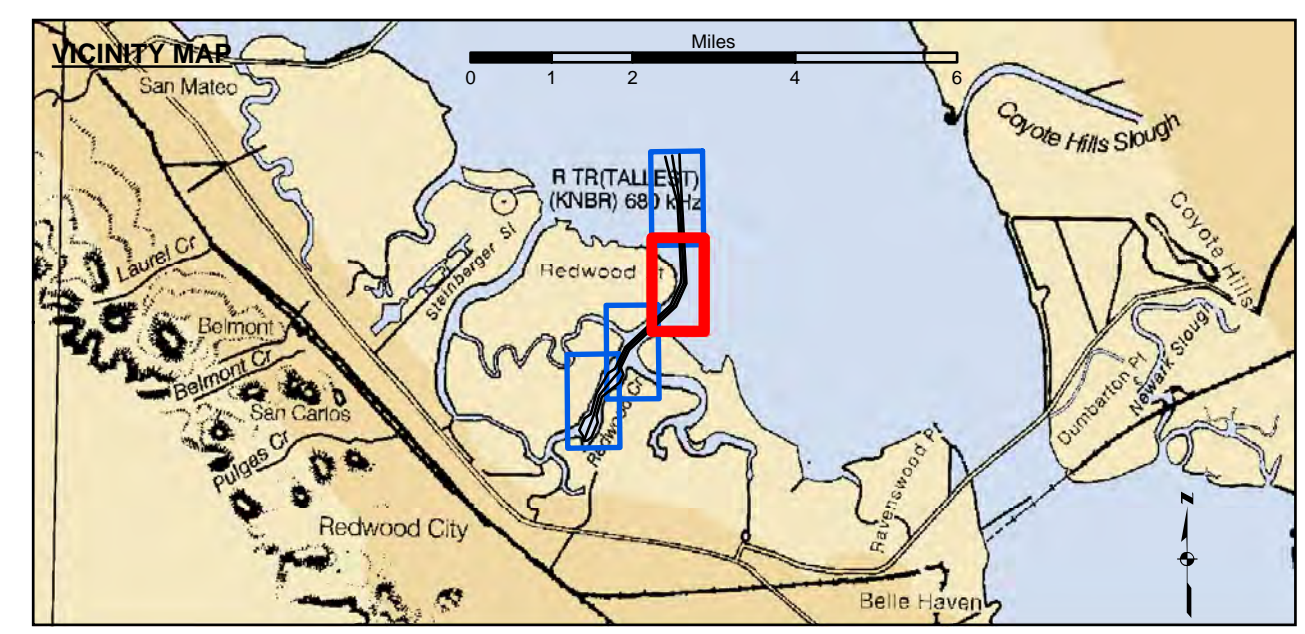

Federal Navigation Channel	Beacon, General	Contours
Shoaling Area	Obstruction Point	
Material Placement Area	Navigation Buoy	
Anchorage Area	Navigation Buoy	
Wreck Area	Shoalest Sounding*	
Submerged Wreck		-30
Angle Point		-29
		-28
		-27
		-26

NOTES:
 DRAWING NOT TO BE USED FOR NAVIGATION. ONLY CHANNEL CONDITION AT DATE OF SURVEY.
 THE LOCATION OF ALL NAVIGATION AIDS ARE BASED ON INFORMATION PROVIDED BY THE U.S. COAST GUARD. BUOY LOCATIONS REPRESENT THE POSITION OF THE SINKER ONLY.
 INFORMATION DEPICTED ON THIS MAP REPRESENTS THE RESULTS OF SURVEYS MADE ON THE DATES INDICATED AND CAN ONLY BE CONSIDERED AS INDICATING THE GENERAL CONDITIONS AT THAT TIME.
 SURVEYED BY THE CORPS OF ENGINEERS.
 *SHOALEST SOUNDING PER QUARTER PER REACH

SOUNDINGS WERE TAKEN BY FATHOMETER AND ARE SHOWN TO THE NEAREST TENTH OF A FOOT. SOUNDINGS ARE BASED ON THE DATUM OF MEAN LOWER LOW WATER AT THE LOCALITY, NAVD 88. BASE MAPS ARE USDA NAIP 2010.
 PLANE GRID, BEARING AND COORDINATES ARE BASED ON THE STATE OF CALIFORNIA COORDINATE SYSTEM, LAMBERT CONFORMAL PROJECTION, ZONE III NAD 83, CALIFORNIA, AS DESCRIBED IN SPECIAL PUBLICATION NO. 235, PUBLISHED BY NATIONAL OCEAN SURVEY.
 THE PROJECT DEPTH IS 30 FEET AT M.L.L.W.
 SOUNDINGS ARE BASED ON THE TIDE GAUGE LOCATED AT RAZ 6 & RAZ 5
 LINES 18+00 TO 100+00 @ BEACON NO. 8
 LINES 101+00 TO 160+00 @ RAZ 6
 LINES 160+ TO 208+49 @ RAZ 5
 VERTICAL CONTROL:
 BENCHMARK, MLLW ELEV., AGENCY
 BM 4501 A, NOS TIDAL DISK, 12.15 MLLW
 BM 4508 U 1998, NOS TIDAL DISK, 11.88 MLLW
 BM 13 1974, NOS TIDAL DISK, 12.99 MLLW
 HORIZONTAL CONTROL:
 DESIGNATION, SOURCE, XYZ
 COAST GUARD D-BEACON.

Sheet Reference Number
 2 of 4